

## Disciplinary Commons January 7, 2006

We are meeting at Pierce College Puyallup Campus in the College Center building. Brief directions from I-5:

- ☉ Take 512 (exit 127 off of I-5) and get off on the Eatonville exit.
- ☉ This places you on 104<sup>th</sup> that immediately merges with Meridian.
- ☉ Proceed and turn left at the third light onto 37<sup>th</sup> Ave.
- ☉ Continue on 37<sup>th</sup> (which becomes 39<sup>th</sup> and Mapquest labels 112<sup>th</sup>) and at the third light turn left onto College Way.
- ☉ Bear left and follow the drive then take the first right into the West parking lot.

The College Center building is at the far end of the lot. You will be entering the building on the second level. Take the stairs down to the first level. Our meeting room is the “Multi-Purpose Room” directly below the second level entrance.

The official directions are at <http://www.pierce.ctc.edu/whereis/py/directions.php3> some of which are duplicated below along with some helpful visuals.

## Directions to Pierce College Puyallup

### ***Coming from the north on I-5:***

- \* Follow I-5 south past Tacoma and take the Puyallup exit to Hwy 512.
- \* Continue east on 512 to the Eatonville exit.
- \* As you exit, continue to the right, after the first light merge to the far left for turning left at the third light, which is 37th Ave.
- \* Go east on 37th Ave, which becomes 39th Ave., for approx. one mile.
- \* You will see the college sign on your left at the entrance to the driveway.

### ***Coming from the south on I-5:***

- \* Follow I-5 north and take the Puyallup exit (127) to Hwy 512.
- \* Continue east on 512 to the Eatonville exit.
- \* As you exit, continue to the right, after the first light merge to the far left for turning left at the third light, which is 37th Ave.
- \* Go east on 37th Ave, which becomes 39th Ave., for approx. one mile.
- \* You will see the college sign on your left at the entrance to the driveway.

### ***Coming from Auburn, Kent, Eastern Washington:***

- \* Take Hwy 167 south to Hwy 512, Olympia-Tacoma exit.
- \* Continue on 512 appx. 5 miles to Hwy 161 south, South Hill/Eatonville exit.
- \* As you exit, turn left over 512, after the first light, merge to the far left for turning left at the third light, which is 37th Ave.
- \* Go east on 37th Ave, which becomes 39th Ave., for approx. one mile.
- \* You will see the college sign on your left at the entrance to the driveway.



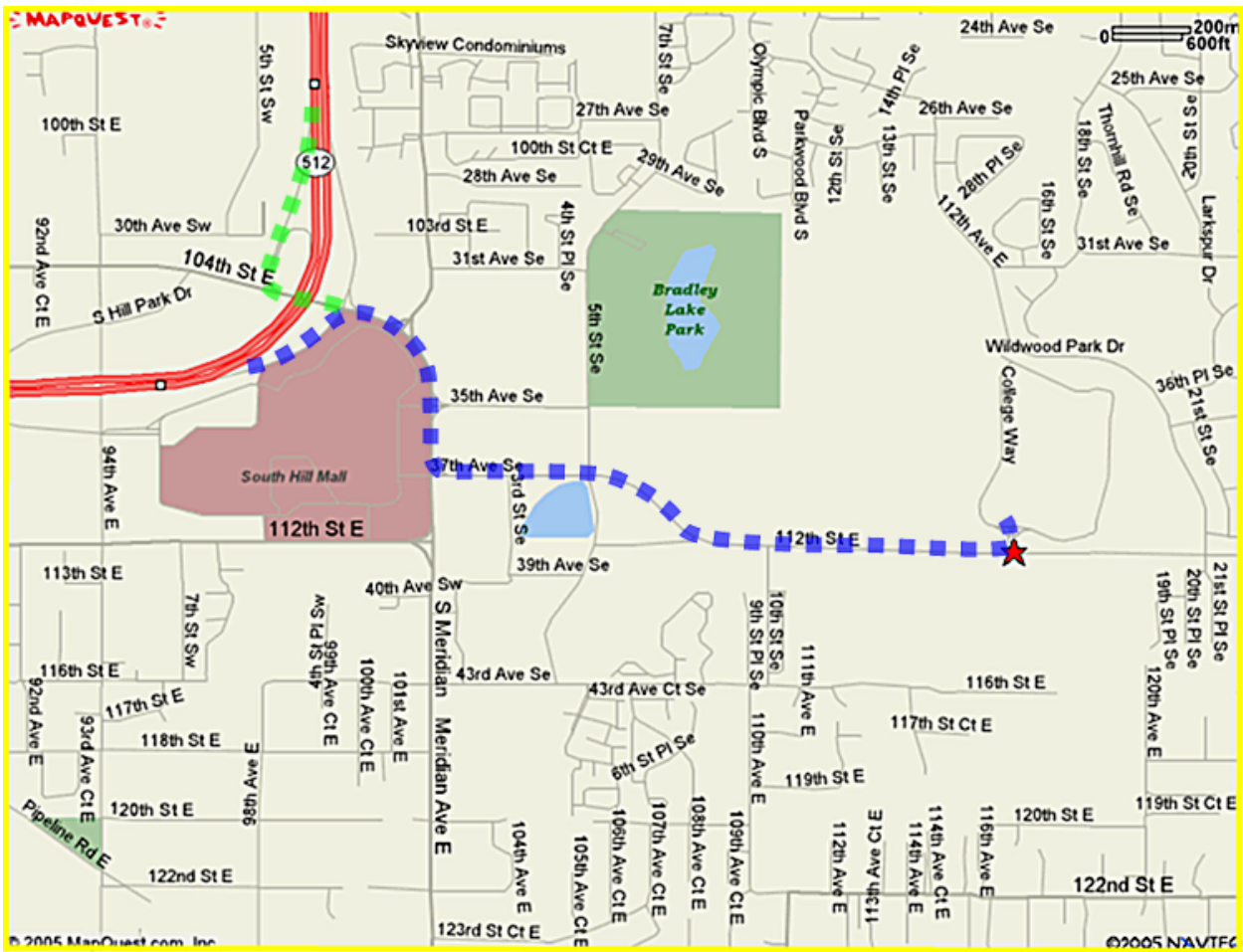
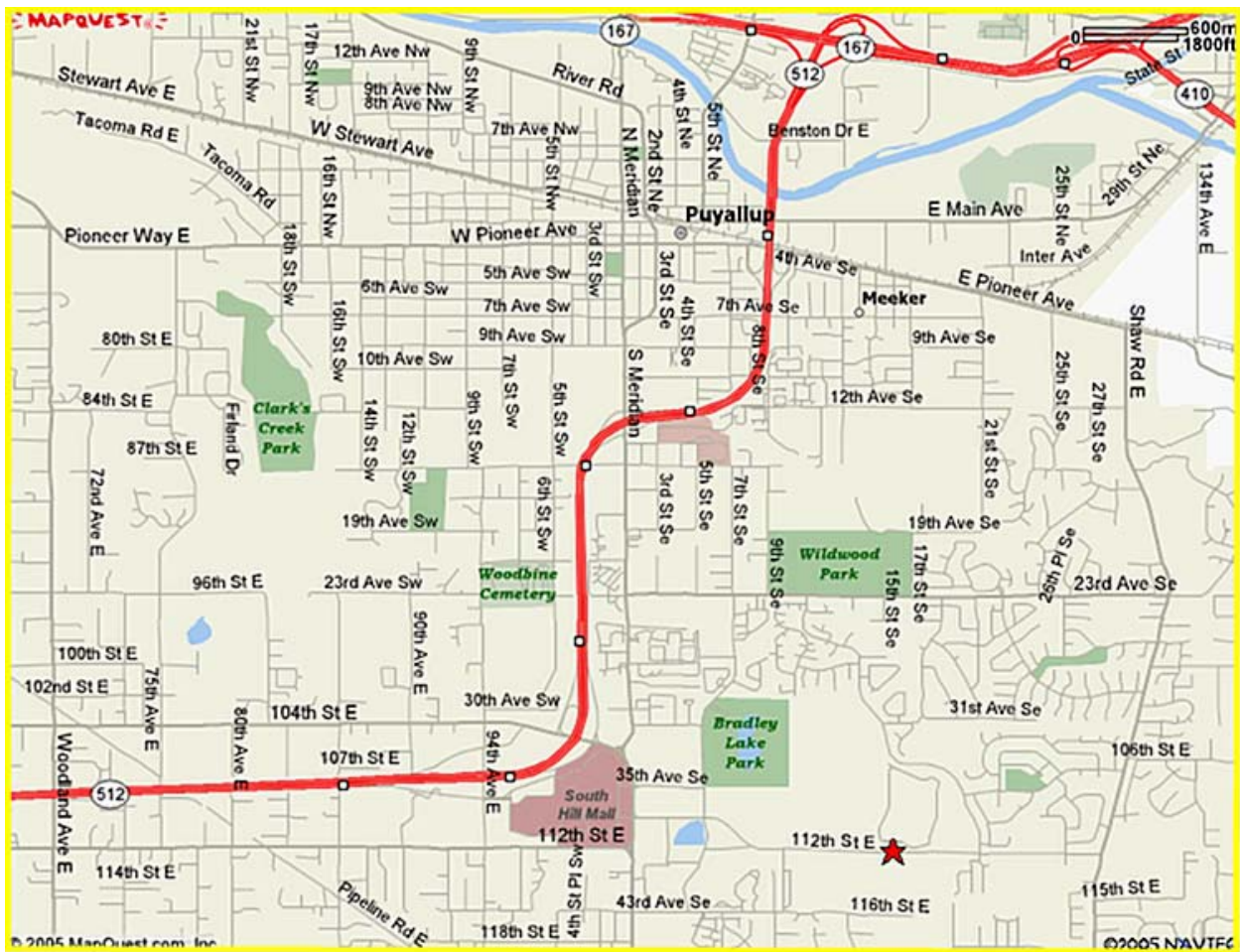

Future entrance 2006

## Puyallup Campus Map

1601 39th Ave SE, Puyallup, WA 98374

**(253) 840-8400**

Welcome to Pierce College Puyallup. The Campus Map will help you locate classrooms and other areas of the college. If you have questions or need assistance, please ask.

### In Case Of Fire Or Medical Emergency Call:

9-911 When using college telephones.

911 When using pay telephones located on campus.

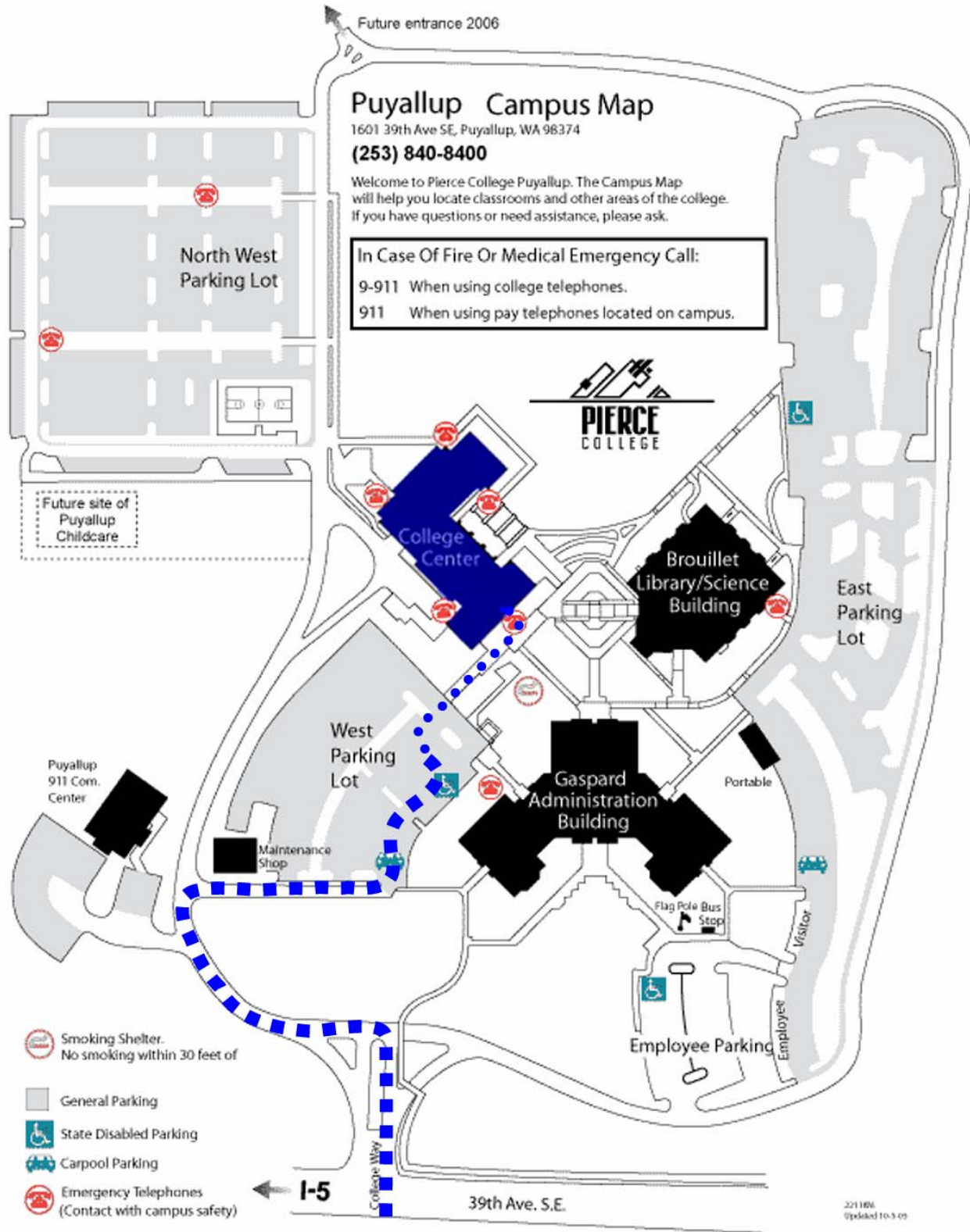

# PUYALLUP COLLEGE CENTER First Level

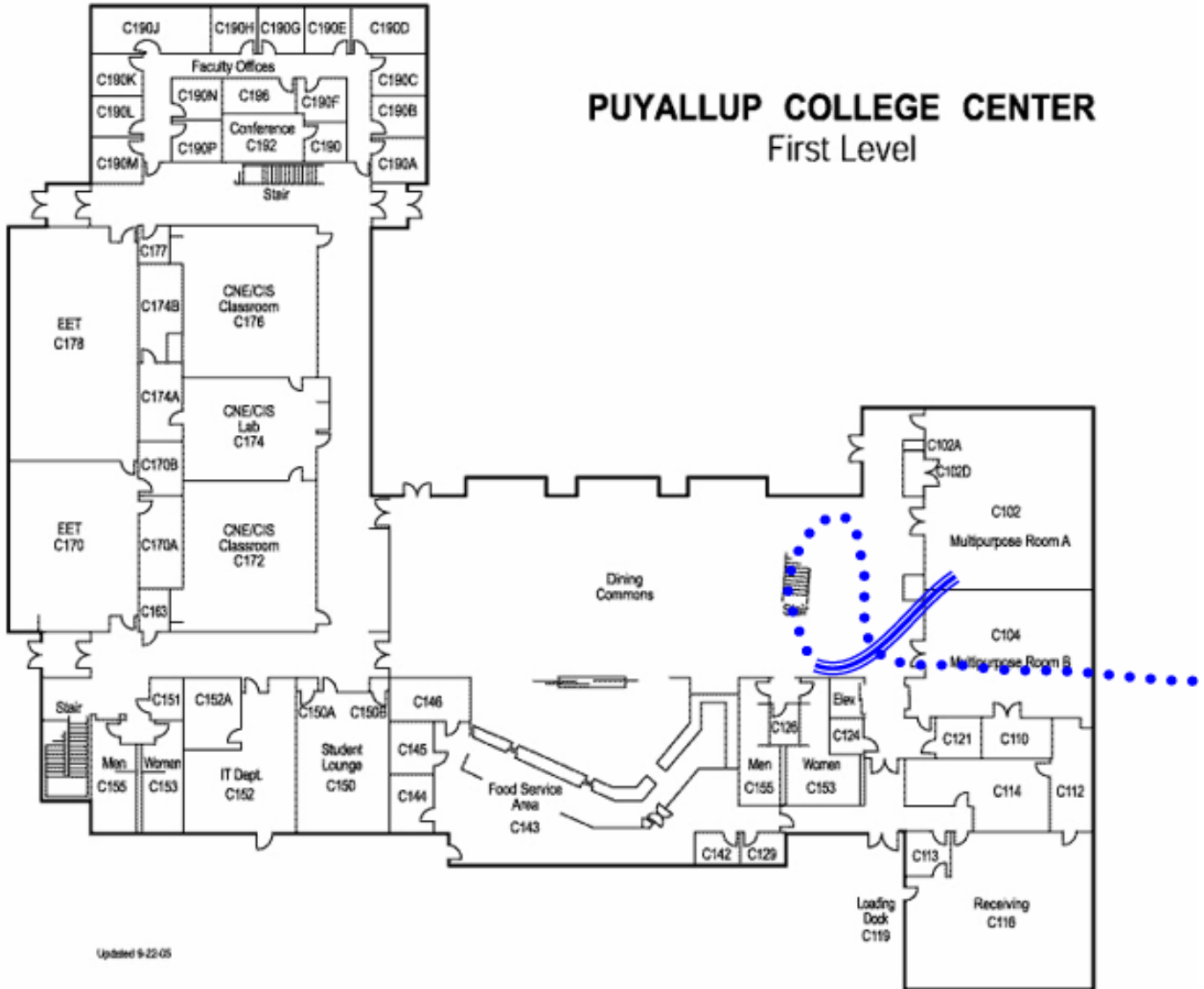

Updated 9-22-05