



Engineering Libraries Division Newsletter

December 2010

Message from the Chair

Bob Heyer-Gray

Inside this issue:

Conference Program Update	2
Awards Committee Call for Nominations	5
Committee Reports	7
Membership	
Newsletter	
People & Places	8
Terman Engineering Library at Stanford	9
Duplicates Exchange	14
Call for Nominations	15
ELD Archives	16



Time certainly does fly ... it has been just under six months since our conference in Louisville and the fall quarter is almost over, all of which means we are already halfway to our next conference in Vancouver, BC. Mike White and the Program Committee have been hard at work planning an excellent program for the conference next June. Make sure to check out the Program Chair's Report for an overview and more details of what the program is going to look like. As I mentioned in my last message, I am really looking forward to Vancouver, doubly so, now that I have a better idea of what the program sessions hold in store. As a reminder for those of you not residing in Canada or used to doing much international travel, please do not forget to take a peek at your passports to make sure they will still be valid in June 2011 (no visa required for U.S. residents).

As you have all probably already seen via ELD-L, the ELD call for awards has gone out (see the Awards Committee call in this newsletter if you missed it). One change of note this year, the award formerly known as the Best Reference Work Award has been replaced by the Innovation in Access to Engineering Information Award. This is not so much a new award as it is a restructuring of the previous award to be less restrictive while at the same time acknowledging that how we access engineering information and the tools we use have changed.

In 2011, the following committees need either to have their current chairs reappointed or have new chairs appointed:

Accreditation and Standards

Membership Directory

Archivist

Mentoring

Awards

Newsletter

Electronic Discussion Lists

Literature Guides (subcommittee of Publications)

Liaisons Program

Scholarly Communication



ELD is a division of the American Society for Engineering Education. Its mission is "to promote and strengthen the role of the library as an integral part of engineering education."

Message from the Chair *(Continued from page 1)*

If you would like to chair any of these committees or re-up for another term, please send me an email briefly describing your interest. I will work with the Executive Committee to make appointments following the ELD Elections in the spring. If you volunteered before, but were not appointed, please do try again if you are particularly interested in a position. Committee chairs are not automatically reappointed, so this could be your year.

For a complete description of each committee just follow the link to the ELD Bylaws (committee descriptions can be found in Addendum 1) from the ELD homepage <http://depts.washington.edu/englib/eld/>.

If you have any questions or suggestions for the Engineering Libraries Division or if you have any new ideas and thoughts about any activities ELD should be involved in, please do not hesitate to let me know.

I wish everyone a joyous and peaceful holiday season.

Bob Heyer-Gray
ELD Chair
bobhg@lib.ucdavis.edu

Conference Program Update

Conference Program Update

Greetings from frosty Kingston, Ontario!

I would like to begin my update by thanking everybody who submitted an abstract for a paper or poster, idea for a panel presentation or workshop proposal. The success of ELD depends on the ideas and contributions of each and every one of our members, without whom we could not offer a quality program year after year. I would also like to thank the members of the ELD Program Planning Committee for all their advice and assistance: Aleteia Greenwood, Larry Thompson, Bob Heyer-Gray, Doug McGee, Craig Beard, Adriana Popescu, Megan Sapp Nelson and Amy Buhler.

I am happy to report that we received 34 abstracts, two panel proposals and one workshop proposal. I was especially pleased by the large increase in abstract submissions (58 percent more than 2010) and the fact that so many were from our Canadian and international members.

In order to accommodate the large number of abstracts, ELD requested 17 sessions, three more than last year. These included seven technical sessions, three panels/forums, three business meetings, one poster session, one workshop, and two social events. Unfortunately, the PIC chairs rejected three of our technical sessions, the professional issues forum and the workshop. Our PIC Chair, Bevelee Watford of Virginia Tech, explained that there was heavy competition for prime time slots due to an unusually large number of abstracts and session requests. She said that Vancouver is shaping up to be one of the most popular ASEE conferences since Honolulu in 2007.

Of course, the loss of three technical sessions was a tough blow to the ELD program. In order to accommodate as many technical papers as possible, we had to bump one of our panels and reorganize some of our sessions. The session topics, in no particular order, are:

- *Reinventing Engineering Libraries: Spaces & Services*
- *Engineering Information: Collections & Access*
- *Information Literacy: Designing Effective Programs for First Year Students*
- *Information Literacy: Preparing Students for the Real World*

Conference Program Update *(Continued from page 2)*

- *To Boldly Go... Librarians Explore New Connections with Students and Faculty*

Our remaining panel, moderated by Sarah Lester of Stanford, will explore *NSF Funding and New Data Initiatives*. Sarah has recruited a panel of librarians from MIT, Stanford and the University of Illinois at Urbana Champaign who will discuss how their libraries' data repository systems are providing support for faculty and researchers. They will cover education campaigns to teach faculty about the data curation process, development of data standards and system implementation, as well as ways of incorporating curated data into information discovery systems.

The ELD Mentoring Committee's friendly Paper Review Service (http://depts.washington.edu/englib/eld/paper_review.php) is an excellent resource for confidential, impartial and constructive feedback on your papers. Do take advantage of it. Here are the upcoming deadlines and important dates:

- January 12, 2011 – Registration and housing open for all attendees
- January 19 – Draft papers due
- February 18 – Draft paper reviews due
- February 25 – Deadline for notifying paper authors
- March 11 – Final and revised papers due

The ELD Business Meeting is scheduled for Tuesday, June 28 at 12:30pm. The Get Acquainted Session is slated for its usual time on Monday, June 27 at 12:30pm. The ELD Extended Executive Committee meeting will be on Wednesday, June 29 at 4:00pm. Last year we introduced "Lightning Talks" into the Get Acquainted Session. These were well received and the Program Planning Committee is planning on offering them again. A call for proposals will go out in the spring. Given the tight schedule, committee chairs will once again have to make time for committee meetings.

ELD is also co-sponsoring with the Liberal Education Division and ten other divisions a town hall meeting scheduled for Monday, June 27, 4:00-5:30pm. Following the Louisville meeting, the Liberal Education Division, after consulting with several PIC chairs, established a Committee on Interdivisional Cooperation with the mandate to explore opportunities for enhancing interdivisional exchange and coordination within ASEE. The town hall meeting in Vancouver will be an open forum for discussing the Committee's preliminary recommendations, which will then be compiled in a form that can be forwarded to the PIC chairs. The meeting will be concurrent with one of our technical sessions, but I expect that ELD representatives will attend and report back to the membership.

Adriana Popescu and Amy Buhler, our two directors, are making the arrangements for the Welcome Reception and Annual Banquet. The Welcome Reception, which is sponsored by IEEE, will be held on Monday, June 27 at 6:00pm at the Steamworks Brewery, located within walking distance of the Vancouver Convention Centre. Details about the banquet will be finalized in January.



Conference Program Update *(Continued from page 3)*

Other conference highlights include the ASEE Picnic on Sunday, the “Greet the Stars” orientation for new ASEE members, and the “Focus on Exhibits” brunch and happy hour. The main plenary session will be on Monday, June 27 at 8:30am. The Focus on the Exhibits & NSF Grantees Poster Session will be on Monday, June 27 at 10:30am. The two Distinguished Lectures sessions will be at 10:30am on Tuesday, June 28 and Wednesday, June 29. (ELD is not sponsoring a Distinguished Lecture this year.) The ELD Poster Session will be on Tuesday, June 28 at 4:00pm.

Of course, Vancouver offers myriad cultural, shopping, outdoor and sightseeing opportunities. A good starting point for planning your visit is Tourism Vancouver (<http://www.tourismvancouver.com/visitors/>). Whistler, BC (<http://www.whistler.com/>), one of the sites of the 2010 Winter Olympics, is less than two hours drive north of Vancouver along the scenic Sea to Sky Highway. If you love coffee, beer and food, Vancouver has hundreds of restaurants, cafes and brewpubs that cater to every style and taste.

Now a few travel tips... As a recent article in the *Globe and Mail* reported, it is usually less expensive to fly between U.S. cities than between U.S. and Canadian cities. If you're traveling to Vancouver from the U.S., you might do a little comparison shopping for airfares to Seattle. There are several companies on both sides of the border that offer express bus and shuttle service between Seatac airport and Vancouver. Adult roundtrip fares start around \$75. Amtrak Cascades train and bus service is also available between Vancouver and Seattle (and down to Eugene, Oregon): <http://www.amtrakcascades.com/>. If you're planning on crossing the border by car or bus, remember to check border wait times at the Washington State DOT website at: <http://www.wsdot.wa.gov/Traffic/border/> and the Canada Border Services Agency website at <http://www.cbsa-asfc.gc.ca/general/times/menu-e.html>.

Finally, I would like to remind our American and international members to make sure that your passports and travel documents are in good order. Don't wait until the last minute to apply for or renew your passport or visa. Although passport application processing times have improved, delays and errors can always happen. I recently renewed my U.S. passport through the U.S. embassy in Ottawa and it took about three weeks. However, I had to wait two more weeks to receive it because of a clerical error.

So mark your calendars for June 26-29, 2011 and remember to keep watching the ELD conference blog and ELD e-mail lists for updates. If you're arriving early or staying after the conference, be on the lookout for CUEBALLS activities too. The preliminary program will appear soon on the ELD website at:

<http://depts.washington.edu/englib/eld/conf/conf11.php>.

Again, I want to express my thanks to everyone who has contributed thus far to planning and organizing what I'm sure will be another outstanding ELD program.

Happy holidays!

Michael White
ELD Program Chair, 2010-11

Conference Buddy Program

Brought to you by the ELD Mentoring Committee
Jay Bhatt, Chair



Are you new to the Engineering
Libraries Division?

Attending your first ASEE Annual
Conference?

Get paired up with an ELD Member to
show you the conference ropes.

Contact Bruce Neville

Email: bn Neville@tamu.edu
Phone: 1.979.845.7572



Awards Committee "Call for Nominations"

Awards Committee "Call for Nominations"

The ELD Awards Committee is seeking nominations for three annual awards. (The fourth award - Best Poster - will be determined at the Annual Conference and Exposition in June, 2011.) Nominations are an essential part of the awards process. This year we have a new award that recognizes new and innovative engineering information resources! The committee welcomes input from engineering librarians and other colleagues.

Ask yourself the following:

- Did you write an engineering information related paper or book in 2010?
- Have you read an excellent engineering information related paper or book written in 2010?
- Have you been impressed by a new resource, service or tool that provides innovative access to engineering information?

Do you know someone who deserves to be recognized for his or her "Distinguished Service" to ELD and/or engineering information?

If you answered "Yes!" to any of these questions, please take the time and effort to nominate each item you said "Yes!" to. Please feel free to nominate more than one worthy candidate. Receiving nominations from a wide variety of perspectives is extremely helpful to the Awards Committee.

The awards are listed below along with basic summaries and their respective requirements. A link to the ELD Awards web page is also included. Send all nominations via regular mail and/or e-mail to:

Alice Trussell
Chair, ELD Awards Committee
Fiedler Engineering Library
137 Hale Library
Manhattan, KS 66506-1200
alitrus@ksu.edu

1. HOMER I. BERNHARDT DISTINGUISHED SERVICE AWARD - Each year at the ASEE Annual Conference, the Engineering Libraries Division presents an award, consisting of a plaque that recognizes work that contributes to the advancement and development of excellence in engineering libraries. Membership in ASEE is not a requirement for this award.

Award nominations must include the name, title, and contact information of the nominee and nominator, nomination rationale statement, and curriculum vitae of the nominee. The rationale statement should not exceed 700 words and should clearly indicate why the candidate is being nominated for this award. Letters of support from individuals besides the person making the nomination may be included.

Deadline for Nomination: February 8, 2011

2. BEST PUBLICATION AWARD - The purpose of this award is to honor the best new paper or non-reference monographic work in engineering information published during the year 2010.

Criteria:

1. Single or multiple authors are eligible. Works authored by Awards Committee members are ineligible during the members' term of service.
2. Work must have been published during the year prior to the year in which the award will be made.
3. Work should represent a significant contribution to the field of engineering information. Work should be scholarly, show evidence of thorough research, documentation, and critical evaluation. It should be clearly

Call for Nominations *(Continued from page 5)*

written and well organized.

Deadline for Nomination: February 8, 2011

3. INNOVATION IN ACCESS TO ENGINEERING INFORMATION AWARD

The purpose of this award is to honor innovation in access to engineering information.

Criteria:

1. Awarded to a person or entity for the creation of a resource, service or tool in any format that provides innovation in accessing, utilizing, or presenting engineering information. Members of the Award Committee are ineligible during the members' term of service.
2. The resource, service or tool must have become available during the two years previous to the year in which the award will be made.
3. The resource, service or tool should represent a significant contribution to the field of engineering information.
4. Resources in all media are eligible.

Deadline for Nomination: February 8, 2011

The ELD Awards web page <http://depts.washington.edu/englib/eld/awards.php> has this detailed information on each award as well as a listing of past recipients.

Remember! Your participation in the nomination process is essential to keeping the Awards a vital part of ELD. Without your nominations, we run the risk of not recognizing the "Best of the Best!"

Thanks to all of you for your time and effort.

Alice

Friendly Paper Review Service

Brought to you by the ELD Mentoring Committee
Jay Bhatt, Chair



Contact Carol Brach

Email: brach.10@nd.edu

Phone: 1.574.631.5070

Have you submitted an abstract for Vancouver 2011?

Would you like some feedback on a paper you are planning to submit for publication elsewhere?

Need help writing your paper?

Want to improve your chances of having your manuscript accepted for publication?



Committee Reports

Membership Directory

ELD members;

I have prepared an October update of the ELD Membership Directory. The URL and password were distributed to the ELD Listserv. If you need the URL and password again, please email me.

I would also be happy to email a .pdf copy to individual current members of ELD on request. Feel free to email or phone the Directory Editor.

(IMPORTANT: Please be aware that access to the ELD Membership Directory is a benefit of membership. The Directory address and password, and the information contained in the Directory should not be reproduced, copied, forwarded, edited, sold, or distributed. We value your privacy as well as others' in the Directory.)

Lisha Li
Membership Directory Editor
Science, Engineering & Patents Librarian
Georgia Tech Library
Phone: 404-385-7185
Email: lisha.li@library.gatech.edu

Newsletter

Four issues of the [ELD Newsletter](http://depts.washington.edu/englib/eld/newsletter/newsletter.php) are produced each year and are posted on the ELD web site at <http://depts.washington.edu/englib/eld/newsletter/newsletter.php>

A link to the current newsletter is distributed to members via the ELD-L listserv. If you require a paper copy of the newsletter, contact the editor:

James Van Fleet
Bucknell University
vanfleet@bucknell.edu
570-577-3235



Reviewers Wanted!

The Mentoring Committee is seeking reviewers for the Friendly Review Service

Task: first review of paper or presentation (not a blind review), commenting on organization, supporting sources/data for premise, clarity of illustrations. This is not a spelling/grammar check!

Qualifications: knowledgeable, busy, quick responder, friendly. (You do this every day; you're already qualified!)

Contact: Carol Brach (brach.10@nd.edu; 1.574.631.5070)

For more information see <http://eldwiki.lib.ucdavis.edu/index.php/Mentoring>

People & Places

Christy Hightower writes:

I've recently rejoined ELD and am looking forward to seeing everyone again at the June conference. An article I co-authored has just been published in the latest issue of "Issues in Science & Technology Librarianship."

Hightower, Christy, and Christy Caldwell. "Shifting Sands: Science Researchers on Google Scholar, Web of Science, and Pubmed, with Implications for Library Collections Budgets." *Issues in Science & Technology Librarianship*, no. 63 (2010), <http://www.istl.org/10-fall/refereed3.html>

Linda Musser from the Pennsylvania State University reports:

Many engineering librarians are familiar with the Technical Report Archive and Image Library (TRAIL) project but there are other digitizing projects that are worth noting. Among these is the CIC-Google Government Documents project, which proposes to create a comprehensive digital collection of U.S. federal documents. The project's scope is limited to print publications that fall within Google's scanning limitations (e.g., no oversized materials, posters, maps, etc.) that were distributed under the Federal Depository Library Program, although some non-depository publications may be included. Since it involves destructive scanning, the project affords selective federal depository libraries with the opportunity to reduce the space needed to house their documents collections while contributing to the development of a significant resource. With a projected final size of between 1 -- 1.5 million volumes, the CIC has made a good start by scanning over 100,000 documents, primarily from collections at the University of Minnesota and the Pennsylvania State University. Minnesota provided materials from 1976 onwards in a wide range of disciplines, with particular strength in documents from the Departments of Agriculture, Interior, and Transportation. The Penn State contributions consisted primarily of Congressional committee documents from 1960 -- 2009. Future contributions include Congressional materials covering 1935 to 1968 from the University of Michigan (Law Library), with materials from the University of Illinois, Indiana University, and other CIC institutions to follow. Access to the scanned materials will be available via Google Books, however, better access to the fulltext is available via the HathiTrust (<http://www.hathitrust.org>). More information about this project is available at <http://www.cic.net/home/projects/Library/BookSearch/GovDocs.aspx>

Terman Engineering Library at Stanford University

Evolving Library Environments: The Terman Engineering Library at Stanford University

Helen B. Josephine, Head Librarian, Terman Engineering Library

After four years of planning, the new Engineering Library at Stanford University opened on August 9, 2010. The vision document for the new library, [SEQ2 Library Vision: The Information Collaboratory](#) informed not only the physical design of the new facility but the staffing, collection and service models as well. The SEQ2 in the title refers to the new Science and Engineering Quad currently under construction at Stanford. From the initial design concept phase, the Engineering Library has been an integral part of the design development for the Engineering Center as the anchor building for the entire new engineering quad.

SEQ2

The new Science and Engineering Quad is comprised of four buildings devoted to interdisciplinary research and teaching in areas of global importance. The anchor of the quad is the Jen-Hsun Huang Engineering Center which houses the Dean's Office, Student Services, the Engineering Library, Forbes Family Café, NVIDIA Auditorium and the Department of Management Science & Engineering.

Terman Engineering Library (continued from page 8)

To the west of the Huang Engineering Center is the Jerry Yang and Akiko Yamazaki Environment and Energy Building (Y2E2) home to the Ward W. and Priscilla B. Woods Institute for the Environment at Stanford, which serves as the hub of the university-wide Initiative on the Environment and Sustainability, the Precourt Institute for Energy, the Department of Civil and Environmental Engineering, the Bill Lane Center for the American West, the Emmett Interdisciplinary Program in Environment and Resources, the Department of Environmental Earth System Science, and the undergraduate Earth Systems Program.

To the north is the Center for Nanoscale Science and Engineering which includes the Edward L. Ginzton independent laboratory as well as the offices of the Department of Applied Physics. User facilities within the building feature some of the most advanced nanoscale patterning and characterization equipment available (complementing the nearby Stanford Nanocharacterization Lab and Stanford Nanofabrication Facility), largely in underground installations to provide the stringent control of vibration, light, and cleanliness that is essential for nanoscale research.

The fourth building to be completed in 2013 is the Bioengineering and Chemical Engineering Building. These four structures, providing a total of more than 550,000 square feet of teaching and research space, form a quadrangle around a central courtyard and connect at the second story and underground levels, creating an 8.2 acre complex. More information on the SEQ2 buildings is available at this site:

<http://sequad.stanford.edu/>

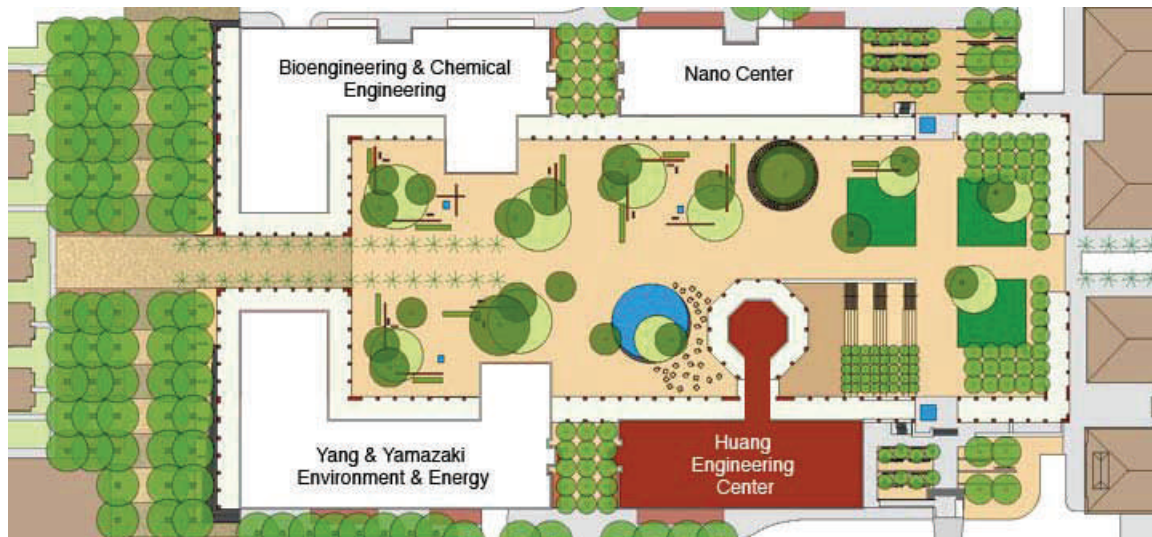

Huang Engineering Center

The Huang Engineering Center is named for Jen-Hsun Huang (MS 1992, EE) co-founder and CEO of NVIDIA, who, together with his wife Laurie made the building possible. The Huang Engineering Center is 130,000 square feet on four floors and includes faculty offices and open areas devoted to student collaboration as well as a student shop for prototype development on the terrace level. In addition to the School of Engineering Dean's office suite and student services for the School of Engineering, this building includes the Department of Management Science and Engineering, two school-wide programs, the Institute for Computational and Mathematical Engineering (ICME), which focuses on simulations and scientific computing, and the Stanford Technology Ventures Program (STVP), dedicated to entrepreneurship education and research.

The outstanding architectural feature of the Huang Engineering Center is the octagon shaped pavilion attached to the center. Each of the four floors of the pavilion has resources to support the School of Engineering and the entire campus community. This includes the 300-seat NVIDIA Auditorium on the lowest

Terman Engineering Library (continued from page 9)

level, the Forbes Family Café on the ground level, the Terman Engineering Library on the second level and the Mackenzie room for conferences and formal events on the top floor. Conference rooms with built-in AV equipment are located throughout the Huang Center and are available for both students and building occupants for meetings and collaborative work.

Frederick Emmons Terman Engineering Library

The official dedication of the Huang Engineering Center was on October 5, 2010. The dedication activities included a symposium on technology innovation in the 21st century with a panel discussion featuring John Hennessy, president of Stanford University; Jen-Hsun Huang, co-founder, President and CEO, NVIDIA; Jerry Yang, co-founder and Chief Yahoo!, Yahoo!; and James Plummer, Dean of the School of Engineering. Tours of the new center and the library were also held along with a dinner for donors and invited guests.

At the dedication, the Engineering Library was officially named in honor of Frederick Emmons Terman (1900-1982) who was a brilliant, though modest, electrical engineer, an inspiring educator, and a visionary and successful university executive. His encouragement of local companies founded by Stanford graduates and the development of the Stanford Industrial Park were instrumental in creating the synergy that is now called "Silicon Valley". Dr. Terman became the Dean of the School of Engineering in 1946 and then in 1955, was appointed Provost and from 1959 served in addition as vice president of the university until his retirement in 1965. He also served on the Board of Directors of Hewlett Packard among other companies. In honor of his service and work he has been awarded the Presidential Medal for Merit; the National Medal of Science, the IRE (now IEEE) Founder's Award; and Stanford's highest, the Uncommon Man Award.

A plaque just inside the door of the new library thanks the donors who made the naming of the library possible as a way to honor this former professor of electrical engineering, Dean of the Stanford School of Engineering and University Provost and to recognize his contributions to the School, the greater Stanford community and the field of radio engineering.

The Terman Engineering Library supports the research and teaching of the School of Engineering and the 65 departmental laboratories, centers, and affiliates programs of the following departments: Aeronautics & Astronautics, Bioengineering, Civil & Environmental Engineering, Computer Science, Electrical Engineering, Management Science & Engineering, Materials Science & Engineering, and Mechanical Engineering. The School of Engineering was founded in 1925 and currently has 240 faculty, 800 undergraduates and 3,300 graduate students. Annually the school confers 400 BS, 950 MS and 250 PhD degrees. About a quarter of all Stanford University students are enrolled in the school. The library also supports the research and teaching of the Physics and Applied Physics Departments. The library is staffed with four subject specialists assigned as liaisons to these departments to both respond to and anticipate the information needs of the students and researchers throughout their personal, professional and academic lives.

Library Mission

Library space and services are designed to foster collaboration among students and faculty, and to support discovery, retrieval and integration of print and digital information. To fulfill this mission the current staff has created a robust website with research guides and tutorials and has re-shaped the collection to include online access to journals, e-books, research publications, materials properties information, standards collections and the online digital libraries of professional societies including ACM, AIAA, AIP, ASM, ASTM, ASME, HFES, ICE, IEEE, INFORMS, IWA, MRS, SAE and SPIE.

Collection Resizing

From July 2007 to March 2010 the Engineering Library shipped 96,000 items to SAL3 the Stanford University Libraries' auxiliary high-density, climate-controlled library material storage facility. This represents 6,000 reference books and indexes, 8,000 School of Engineering dissertations, 46,000 journals,

Terman Engineering Library (continued from page 10)

conference proceedings, technical reports and 36,000 books. We have converted our journal collection to e-only with the exception of 100 titles which we must retain in print due to our license or prefer to have in print for browsing.

As part of the planning for the new library, a decision was made to include the Computer Science collection in the new library. Formerly part of the Mathematical and Statistics library, the CS collection was integrated into the Engineering Library with the transfer of 3,700 items over spring break 2010. In addition, 9,400 items from the CS collection were sent to SAL3 for storage. Liaison and collection development responsibilities for the CS department were also transferred to the Engineering Library staff.

At the request of Library and University administration, the integration of the Physics Library collection was added to the planning process in June 2009. Before the move to the new facility in July 2010, 2,700 items were transferred from the Physics Library to the Engineering Library and 20,420 items from the Physics Library were sent to storage. The Physics Librarian was also transferred to the new Engineering Library and she now provides library support for the faculty and students of the Physics and Applied Physics departments from the Engineering Library.

Yes, but is it Bookless?

The "bookless" library has stack space for 20,000 high-use books, a small collection (approx 100 titles) of journals for casual reading, and special cases for the Timoshenko and Terman book collections. The books in the Stephen P. Timoshenko collection were given to Stanford in the 1950's and represent the personal library of Professor Timoshenko covering the history of mechanics. Housed on-site in glass front cases are 950 items of the 2270 items in the total collection some of which are housed in the Special Collections department and some in our off-site facility.

The Terman Book collection was donated to the library when Dr. Terman retired from the University and for the most part represents personal copies of the various editions of his works in English and foreign language editions presented to him by friends, translators or publishers. These books are housed in a special case built for the collection. Above the case is the portrait of Professor Terman from the former the Terman Auditorium. For more information on these special collections and our collection of Durand-Lesley Propellers see this page on our website: <http://lib.stanford.edu/terman-engineering-library/special-collections>.

We currently have 10 high stack ranges and 3 low stack ranges across the width of the library. These shelving units currently hold 16,500 volumes with one of the tall ranges devoted to journals and the SoE Dissertations for 2008, 2009 and 2010. Our plan to have at least two years of print copies of dissertations from the School of Engineering needed to be modified due to the development of a electronic thesis and dissertation program by the University Libraries and the Office of the Registrar. For 2010 the majority of the dissertations from the School of Engineering were filled electronically and we no longer have a print copy in the Engineering Library. The only archival print copy on campus resides in the Stanford University Archives and Special Collections.

Library Furnishings and Floor Plan

The new Engineering Library features a 3M RFID self-checkout and book security system for library materials, rolling white boards, areas for solo and team work, movable furniture, a digital bulletin board, and wireless access with lots of power and network outlets, as well as great views from the balcony and study carrels.

The Library has 6000 sq ft of space which includes the area with workspace cubicles for the 4 librarians and the Digital Technology Manager for the branch. Adjacent to the library is a 450 sq ft workroom, for materials processing, reserve books, shipping & receiving, and the staff refrigerator. Under the emergency stairwell in a locked room are the computers for the digital video surveillance system, the server for the digital bulletin

Terman Engineering Library (continued from page 11)

board, and some storage of extra book carts. The main area of the library has eight study tables with three chairs at each table. The tables and chairs are foldable, stackable and moveable, allowing as much flexibility as possible for the main entrance area of the library.

At the large windows on the east and west sides of the library are the popular high backed study booths with seating for 4 at each of the two booths. The Library also has installed on one large table a computer cluster of 6 computers supported by the School of Engineering with the software students need to complete class assignments. We added a height adjustable table for one of the School of Engineering supported computers. Along each of the east and west sides of the library are 10 individual study tables, 5 per side. Each of these tables has access to a power outlet and a high speed data jack. Each also has an LED lamp and a window. The tables and chairs used for these study carrels are also moveable, should we decide to reconfigure this area. At the south end of the library, directly across from the entrance are 6 arm chairs with built in tables and 4 footstools. In this area, floor jacks provide power for laptops and cell phones. The arm chairs and footstools are moveable and are usually arranged in a semicircle facing out toward the large window and balcony. The balcony has two tables and 6 chairs with enough room for short pacing to clear the brain; however, the space is usually used for cell phone conversations. We have created a Picasa web album with photos of the interior of the library: <http://picasaweb.google.com/engreference/NewLibrary?feat=directlink#>

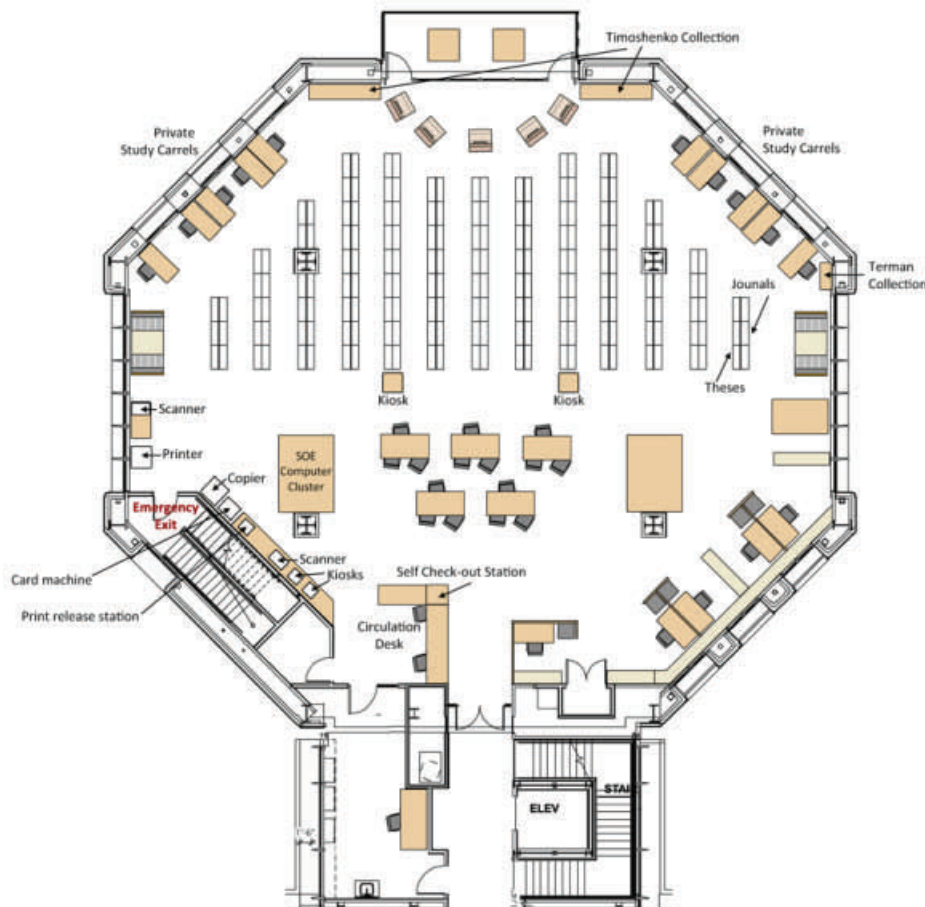

Terman Engineering Library (continued from page 12)

Technology

Digital Bulletin Board: 60" Sharp Aquos and Exhibio server and software for library events and information plus School of Engineering events, student projects

Circulating e-readers: 8 Kindle 2 readers , 2 Kindle DX readers and 8 Sony e-readers

Rolling display: 60" Sharp Aquos with touch capability using e-beam for group presentations

Two collaboration worktables with 24" monitors for student project work

Information Kiosk: 23" HP Touch screen computer for basic library information

3M RFID system for book self-check out and security

iPhone/iPad for reference questions and to test mobile research apps

Wireless access throughout the library

We are currently developing the concept of a "widget bar" --a place in the library for hands-on experimentation with digital devices. We plan to add a security system similar to those used in electronics stores to one of the study tables and attach an iPad, a Kindle DX, and a Sony Touch for use in the library only. Other e-readers can be checked out for 28 days with no renewal. The devices are cataloged and listed in our online system with the contents note listing all of the titles on the device. We also maintain web pages for the Sony and the Kindle readers which list the content on each device.

Kindle page: <https://lib.stanford.edu/?q=engineering-library/engineering-library-kindle-page>

Sony reader page:

<https://lib.stanford.edu/?q=terman-engineering-library/engineering-library-sony-touch-e-reader-page>

Library Services and Liaison Model

Information support for students and faculty is provided by librarians using a liaison model with each of the librarians assigned to support at least two departments. Liaison duties include collection development for the assigned departments, which encompasses print books and journals, electronic books and journals, databases, data sets, standards, electronic courses, video, evaluation of gifts and departmental publications. In addition, liaison librarians are expected to interact with faculty and offer in-class instruction session on resources and develop web-based class guides and research guides for each department. We all participate in the workshop sessions we hold each quarter on citation tools, searching multiple databases, and linking resources into the course management system. The Terman Engineering Library does not have a reference desk, but we do provide reference assistance using e-mail, web-based chat, text and voice on the iPhone. We also respond to walk up requests at our individual desks and referrals from the circulation desk.

We use our web pages and our Facebook page to communicate with our students and faculty. We highlight and announce new resources, workshops, funding opportunities, new books, and student events on our blog. Our web pages can be found at: <http://lib.stanford.edu/englib> and more information on the new library including links to articles about the library are included in the New Engineering Library section. As stated in the vision document for the new library, "The primary role of the librarians is to *make information and knowledge accessible* regardless of format."

The vision document also summarized the service themes of the new Engineering Library which we have embraced: high-touch human contact, mediation and subject expertise and mutability or continuous change and experimentation. We anticipate that more innovative information resources and devices will be available to us as we continue to evolve as a "bookless" library.

Duplicates Exchange

The Duplicates Exchange is back!

After a bit of a hiatus, Linda Yamamoto has taken over the coordination of the ASEE/ELD Duplicates Exchange program from long-time coordinator Orion Pozo. The Duplicates Exchange is a way for members to offer up or request duplicate items that may be of interest to other engineering librarians. Linda also sorts through emails sent to the BACKSERV and DEU lists and forwards the edited lists to the group.

She is working off Orion's last version of the list, so if you wish to add yourself to the list, please email her at [linday\(at\)stanford.edu](mailto:linday(at)stanford.edu). Also, if you're receiving (or thinking of receiving) Duplicates Exchange emails, Linda would like some feedback on what subject areas should be covered. For example, should it include items from scientific areas (e.g., Nature journals) as well as engineering?

Linda Yamamoto
Head Librarian & Bibliographer
Mathematics & Statistics Library
Stanford University



Seeking Conference Buddies

Remember your first conference? Did you spend an hour in the registration line? Did you find the right meeting room the first time? Did you come with a project in mind but never found the people who had similar ideas?

So volunteer to be a Conference Buddy! Meet new friends! Show a colleague why the ELD meetings are as good for networking as they are for new/improved ideas.

Contact Bruce Neville (bneville@tamu.edu; 1-979-845-7572)

For more information see <http://eldwiki.lib.ucdavis.edu/index.php/Mentoring>

Call for Nominations

Call for Nominees for Secretary/Treasurer and Director

As plans are underway for the Vancouver conference, future opportunity is knocking! New officers must be elected to serve 2012 and beyond. Are you looking for a way to get more involved in ELD? The ELD Nominating Committee is looking for members willing to run for one of the two elected positions within ELD: Secretary/Treasurer or Director.

There are some basic facts you need to know before you agree to run.

The person elected to Secretary/Treasurer position is committing to a four-year officer track within ELD. The Secretary/Treasurer moves on to be the Program Chair in their 2nd year, the Division Chair in their 3rd year, and the Past Chair/Nominating Committee Chair in their 4th year. The first three of those four positions include service on the Executive Committee (EC), the five person primary governing body of ELD, as well as on the Extended Executive Committee (EEC). The Past Chair is a member of the EEC, but not the EC. The person elected as Secretary/Treasurer this spring will assume office as of the end of next summer's conference in Vancouver, BC, serve in this office through the 2012 conference in San Antonio, Texas, and serve as Program Chair and plan the 2013 conference in Atlanta, Georgia.

The second position is one of two Directors, who serve alternating two year terms. In the first year, the Director organizes the Tuesday night ELD banquet. In the second year, the Director organizes the Monday night welcome reception. Directors are members of the EC and the EEC for both years. The person elected as Director this spring will organize the banquet for 2012 in San Antonio, Texas and the welcome reception in 2013 in Atlanta, Georgia.

More complete descriptions of officer responsibilities appear in Addendum 1 to our division bylaws, sections 1-5, and can be found at <http://depts.washington.edu/englib/eld/bylaws.php#addendum1>

As the officer in the fourth year of the Secretary/Treasurer through Past Chair service commitment (aka "the gauntlet"), my time during the preceding three years was full of opportunities to learn about the workings of ELD and ASEE and help set future directions for the division. I am shocked at how quickly the time has gone. The experience has been enjoyable, enlightening, rewarding, and busy. I heartily encourage you to look at the opportunities being an officer presents, as well as the commitments that are required, and consider running for either Secretary/Treasurer or Director. Many ELD members have served in these positions and are more than willing to help new officers succeed.

The Nominating Committee this year consists of John C. Teleha, Nancy Linden, and Jill Powell. It is our responsibility to announce this "Call for Nominations" to the rest of the membership, to cull a slate of candidates for each position, to administer the election in March, and report the results to the ELD membership. Please let us know if you are interested in running for office, if you want to suggest someone else who you think would make a good officer, or if you have any questions. Self-nominations are both encouraged and accepted.

You can contact the Nominating Committee at: eld-nominations@u.washington.edu .

John C. Teleha Chair, Nominating Committee
teleha@ncat.edu

ELD Archives

We are reprinting here an article from the March 2010 Newsletter, with the responses we received from ELD members. Consider these photos identified!

A big thank you to Carol Solomon, Sharon Siegler and Mel Desart for their responses about the photos in the March newsletter . Another big thank you to Amy Van Epps for a tie breaker. All of the messages were articulate and fun to read -- what else should we expect from ELD members? To do them justice I'll quote extensively. Mel Desart gets extra credit for providing affiliations (omitted in the interest of space) for most of the identifications.

To Be Identified . . .

This is the first of an irregular segment "To be identified." It's lovely to receive your photos (in paper or electronically) it's also helpful to have them annotated with: date (including year) location, and names of the people in the photo. Some of these had some information on the envelope in which they were enclosed: "Montreal," "Restaurant in Old Town Albuquerque" some of them — nothing

Please help us identify, by photo number, the date, location, people (and if possible where they were employed at the time) and any brief reminiscence you wish to share. Since corroboration is useful we'll wait until we have received everyone's comments and then communicate both the full information and the people who supplied it. Yes, one of the photos includes one of the archivists. She does know who she is -- she hopes others know who she is also.

Photo #1



Photo 1) Tom DePetro

Mel: "Photo one is Tom DePetro under the table. Not sure where or when on this one, but that's definitely Tom. Depending on year, it could have been when he was at Wichita State or (maybe) Texas A&M."

Photo #2



Photo 2) Albuquerque, 2001, restaurant in the Old Town area (per Mel) l-r Karen Grieg, Carol Solomon, Christina Byrne, Paige Gibbs, Tom Volkening

Carol: "I'm the one in the pumpkin-colored shirt with her back to the camera. I'm betting that that photo was taken in Albuquerque, 2001, because of the Southwestern decor (and the age of that shirt)."

Photo #3



Photo 3) Albuquerque, 2001 same restaurant, l-r unidentifiable, Christy Hightower, unidentifiable, Glee Willis, Karen Clay, Linda Yamamoto, unidentified, Karen Andrews, Sharon Siegler (red hair in foreground)

ELD Archives (continued from page 15)

Photo #4



Photo 4) Montreal 2002 **InterContinental Montreal in a stone vault beneath an adjoining building** (per website)

l-r (among the unidentified) Tom Volkening, Ann Morgan, Carol Resco, Craig Beard, Sharon Siegler, Judy Luther.

Mel:” Photo four is of the cocktail hour from the conference in Montreal in 2002 Kind of a cool location.”

Sharon:” I’m in picture number 4. Aside from the red hair, the fist wrapped around a snifter of scotch confirms it. I’m also wearing a dress (it’s probably the last time...)”

This photo was identified as two different conferences, so I asked a couple of people what information they could give to help break the tie.

From Amy Van Epps:

“This photo is older than Chicago, you can tell from the long maroon ribbon on Sharon’s name tag. We stopped using those while I was membership chair, which pre-dates my time through the officer track. Based on my email archive we started the conversations about another form of ELD identification on nametags in Nov. 2004, so the photo has to be 2004 conference or before. Additionally, I can identify Craig Beard in the background, and his join date with ASEE is in Jan. 2001 (helpful not getting rid of stuff sometimes).

2001 – Albuquerque, 2002 – Montreal, 2003 – Nashville, 2004 – Salt Lake City

Given the wine glasses, etc. that can be seen it’s most likely that this is during cocktails before the banquet... Now, for the process of elimination.

It’s not the Albuquerque banquet, as that was in an outdoor covered patio space and we were at tables from the start... I’m pretty sure it’s not the Salt Lake city space, as that was a nice banquet hall with an outdoor balcony type space... Basically that space would have been more well lit than this picture. So I’ve got it down to 2002 in Montreal or 2003 in Nashville. I think I can recognize David Fiander, from University of Western Ontario in the background, which makes me lean toward Montreal, which was his first conference. I don’t recall if he made it to Nashville.

Paige Gibbs
Co-Archivist