

# Index to UWMC Floor Maps

June 2007

DEPARTMENT/AREA	LEVEL	PHONE	DEPARTMENT/AREA	LEVEL	PHONE
8N Conference Room	8th Floor	598-4800	Neurological Surgery Clinic SP	3rd Floor	598-5637
8SE Clinics	8th Floor	598-8300	Neurology Clinic 8S	8th Floor	598-7688
Admitting	3rd Floor	598-4310	Neurology Unit 4NE	4th Floor	598-4422
Anatomic Pathology	2nd Floor	598-6400	Neurosurgery Unit 4NE	4th Floor	598-4422
Angio-VIR	2nd Floor	598-6200	Nuclear Medicine Clinic	2nd Floor	598-6200
Anticoagulation Clinic SP	1st Floor	598-4847	Nutrition Clinic 7E	7th Floor	598-6004
Blood Draw Laboratory Services	3rd Floor	598-6153	Oncology Concierge Desk	8th Floor	598-3972
Cancer Center	1st Floor	598-4100	Oncology Pharmacy 8SE	8th Floor	598-3895
Cancer Library 8SE	8th Floor	598-7880	Ophthalmology Unit 6SE	6th Floor	598-4410
Cardio/Thoracic ICU 5SE	5th Floor	598-6500	Oral Surgery Unit 6SE	6th Floor	598-4410
Cardiology Surgery 5NE	5th Floor	598-4500	Orthopaedics Unit 6SE	6th Floor	598-4410
Cardiovascular Procedures Waiting Rm	2nd Floor	598-4077	Otolaryngology Unit 4NE	4th Floor	598-4422
Care Coordinator 5N	5th Floor	598-4370	Otolaryngology Head & Neck Srgy (ENT)	3rd Floor	598-4022
Cashiers	3rd Floor	598-4187	Pain Center	1st Floor	598-4282
Clinical Research Center 7S	7th Floor	598-4730	Pathology	2nd Floor	598-6400
CT/MRI	2nd Floor	598-6200	Pharmacy, 1st Floor - After Hrs/Outpatient	1st Floor	598-4363
Digestive Disease Center SP	3rd Floor	598-4377	Pharmacy, 1st Floor - Inpatient	1st Floor	598-4088
EEG/Evoked Potential Lab	2nd Floor	598-4211	Pharmacy, - Outpatient	3rd Floor	598-9949
Emergency Medicine	2nd Floor	598-4000	Pre-Anesthesia Clinic SP	3rd Floor	598-5053
EMG/SEP Service 8S	8th Floor	598-4828	Pre-Surgery Clinic SP	3rd Floor	598-5053
Employee Health	2nd Floor	598-4848	Prostate Oncology Center SP	1st Floor	598-6088
Environmental Services	Basement	598-6181	Psychiatric - Outpatient 7E	7th Floor	598-7792
Escort/Services	3rd Floor	598-4457	Psychiatric Unit - Inpatient 7N	7th Floor	598-4720
Evening Blood Draw Lab	2nd Floor	598-6224	Pulmonary Diagnostic Services	2nd Floor	598-4265
Eye Center	3rd Floor	598-4011	Quiet Room	2nd Floor	
Family Medicine Units 6NE	6th Floor	598-6800	Radiology	2nd Floor	598-6200
Financial Counseling UWMC	3rd Floor	598-4320	Regional Heart Center	3rd Floor	598-5762
Financial Counseling UW Physicians	3rd Floor	598-4319	Registration	3rd Floor	598-4310
Food & Nutrition Services	1st Floor	598-4151	Rehab Patient & Family Library 8N	8th Floor	598-4800
General Medicine Unit 6NE	6th Floor	598-6800	Rehabilitation Gym 8E	8th Floor	598-4830
General Surgery Unit 4NE	4th Floor	598-4422	Rehabilitation Medicine Clinic 8S	8th Floor	598-4295
Gift Shop	3rd Floor	598-4900	Rehabilitation Therapy 8E	8th Floor	598-4830
Gynecologic Oncology Unit 7SE	7th Floor	598-4818	Rehabilitation Unit - Inpatient 8N	8th Floor	598-4800
Healing Garden	3rd Floor		Renal Medicine Unit 4SE	4th Floor	598-4400
Health Information Resource Center	3rd Floor	598-7960	Respiratory Care Services	4th Floor	598-4444
Hematologic Oncology Unit 7SE	7th Floor	598-4818	Security	2nd Floor	598-4082
HSCT Transplant Unit 7NE	7th Floor	598-7770	Short Stay SP	2nd Floor	598-9811
HSCT Transplant/Oncology ICU 8NE	8th Floor	598-8902	Smoking Area	3rd Floor	
ICU-Intensive Care Unit 5E	5th Floor	598-4545	Social Work 5N	5th Floor	598-4370
Imaging Services	2nd Floor	598-6200	Special Procedures Unit 4S	4th Floor	598-4670
Information Desk	3rd Floor	598-6555	Spiritual Care	5th Floor	598-4630
Infusion Room 8SE	8th Floor	598-4296	Surgery Reception SP	2nd Floor	598-9800
Interpreter Services 7E	7th Floor	598-4425	Surgery Waiting Room SP	2nd Floor	598-9800
ISIS SP	1st Floor	598-3244	Surgical Specialties Clinic SP	3rd Floor	598-4477
Kidney Care	3rd Floor	598-7373	Tea Room	3rd Floor	598-9891
Kidney Dialysis Unit 4SE	4th Floor	598-4400	Telemetry 5NE	5th Floor	598-4500
Labor and Delivery Unit 6E	6th Floor	598-4616	Transplant IC Unit 5E	5th Floor	598-4545
Labor and Delivery Antepartum Unit 6S	6th Floor	598-4616	Transplant Clinic	3rd Floor	598-7373
Lactation Services 6N	6th Floor	598-4628	Transplant Services Administration 4E	4th Floor	598-6700
Liver Care	3rd Floor	598-7373	Transplant Surgery Unit 4SE	4th Floor	598-4400
Lost & Found	Basement	598-4909	Travel Medicine	2nd Floor	598-4888
Lung Care	3rd Floor	598-4615	Ultrasound	2nd Floor	598-6211
Maternity and Infant Care Clinic	3rd Floor	598-4070	Urology 7SE	7th Floor	598-4818
Medical Consult Service SP	3rd Floor	598-5160	Urology & Urogynecology Clinic SP	1st Floor	598-4294
Medical Records	3rd Floor	598-0529	Vascular Diagnostic Services SP	1st Floor	598-4449
Medical Specialties Center	3rd Floor	598-4615	Vascular Surgery 4SE	4th Floor	598-4400
Mother-Baby Unit 5S	5th Floor	598-5600	Volunteer Services	3rd Floor	598-4218
Neonatal Intensive Care 6N	6th Floor	598-4606			

North, South & East - Use Pacific Elevators

NE & SE - Use Cascade Elevators

SP = Surgery Pavilion

UWMC Operator: 206-598-3300

LEVEL **3** MAIN FLOOR  
 June 2007  
 UNIVERSITY OF WASHINGTON  
**MEDICAL CENTER**  
 UW Medicine

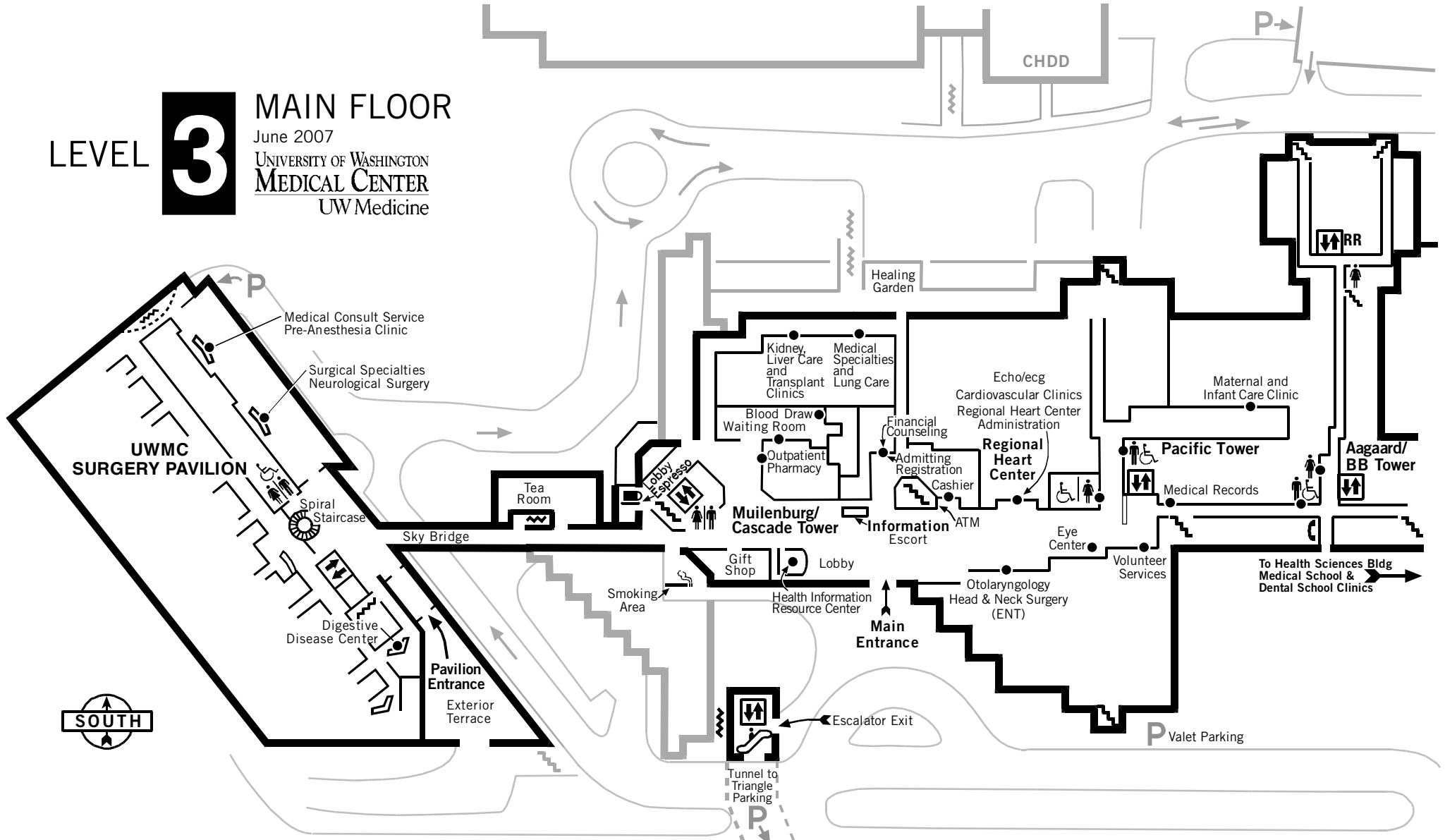

KEY	
	Shuttle
	Cash Machine (Level 1)
	Elevator
	Escalator
	Espresso Bar (Levels 1 & 3)
	Parking
	Restaurant
	Restrooms
	Smoking Area (In designated area only (Level 3))
	Stairs
	Telephone
	TTY telephone
	Wheelchair access

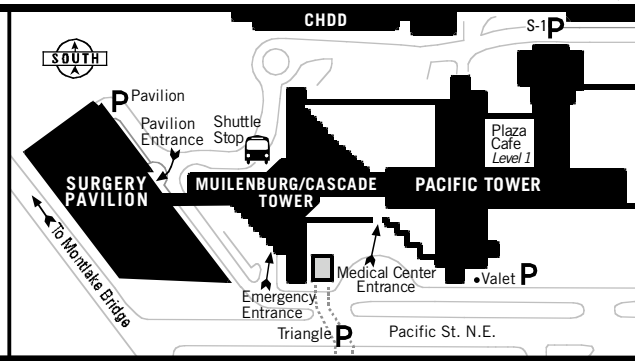

**NOTES**

UH1650 (Rev. June 07) - MapUWMC/Floor 3  
 UH1647 (Rev. June 07) - MapUWMC/AIFloors