

OPEN SPACE 2100 - DUWAMISH TEAM: CITY PLAN

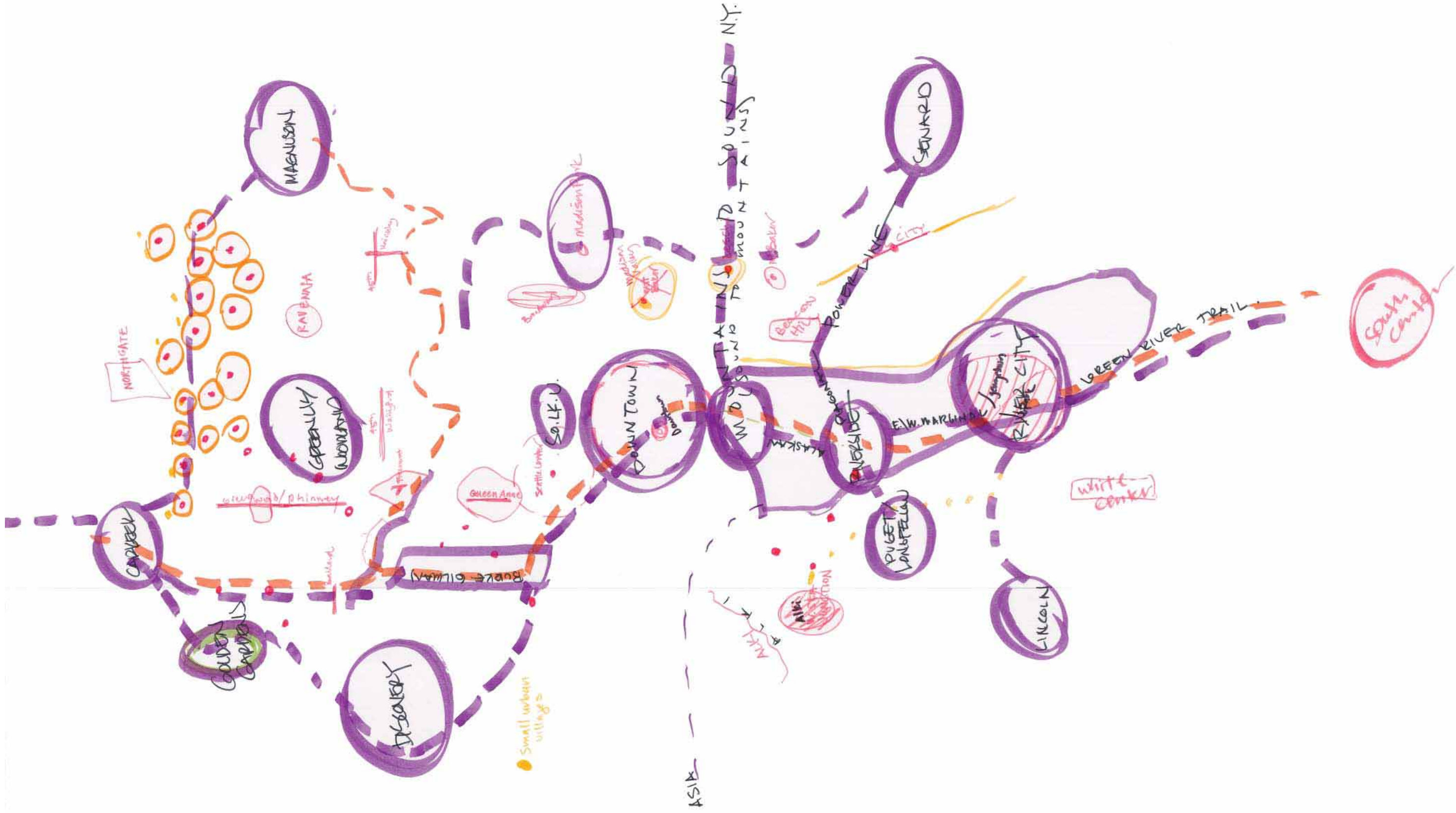

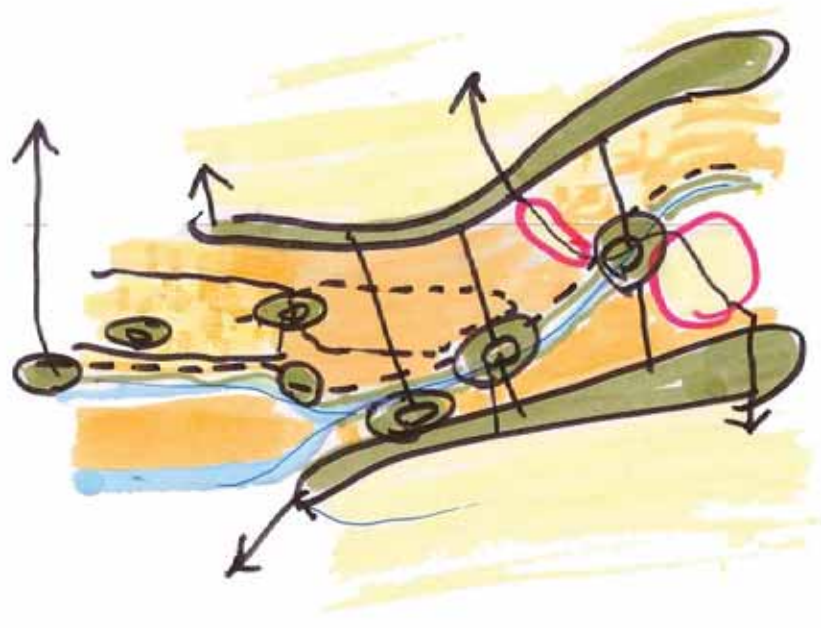

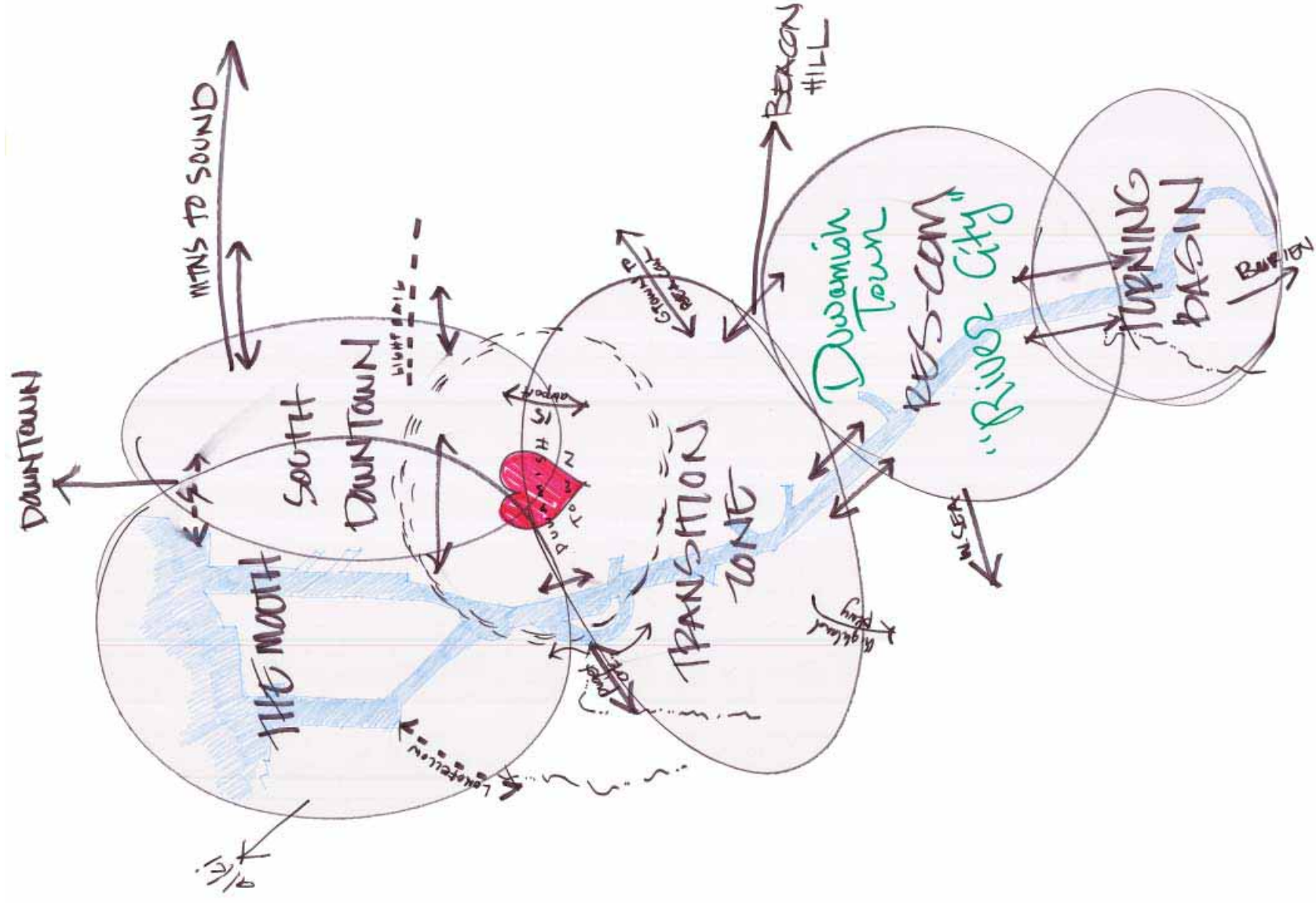
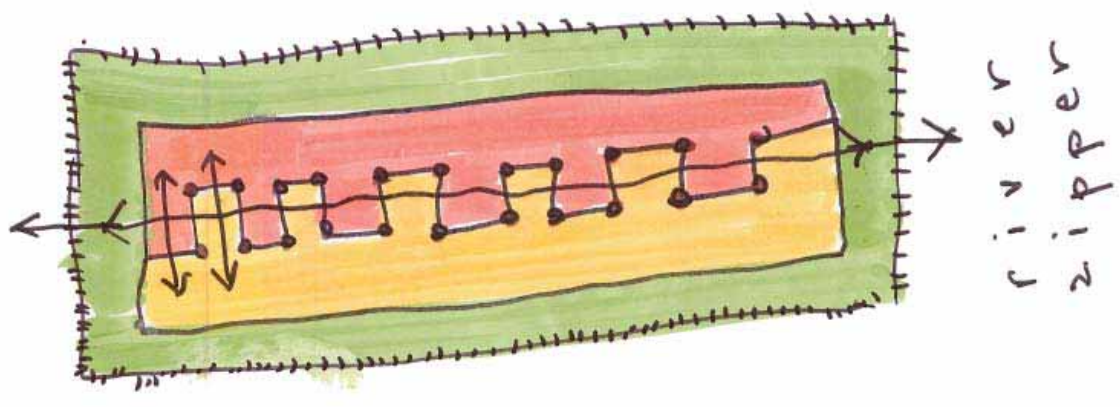
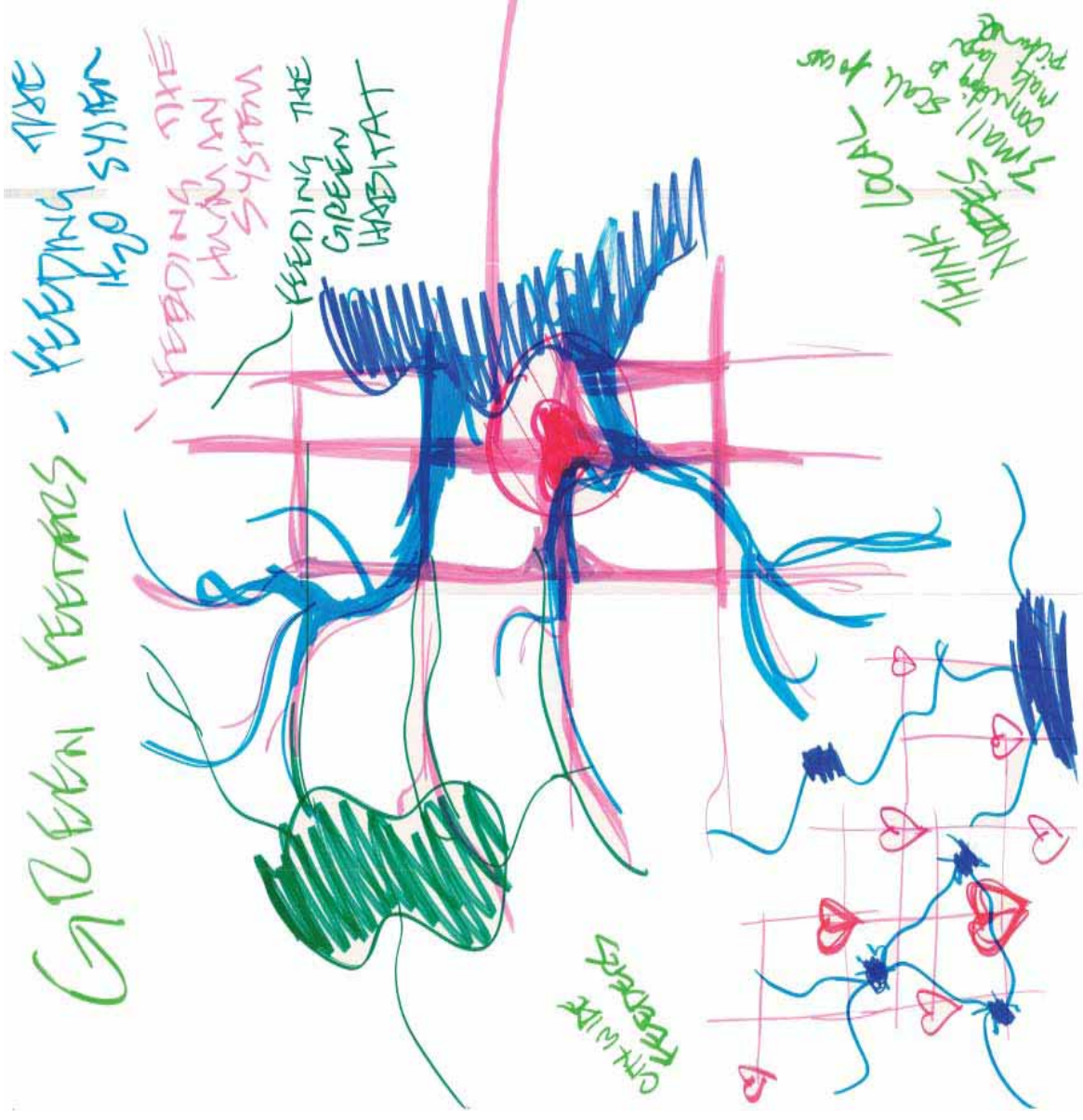
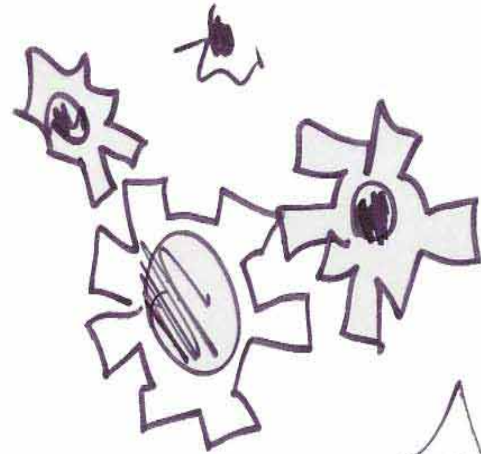

COGGS

WITH TEETH THAT INTERACT OTHER
MOVE EACH & WHOLE
TO CREATE FUNCTIONING

ENGINE

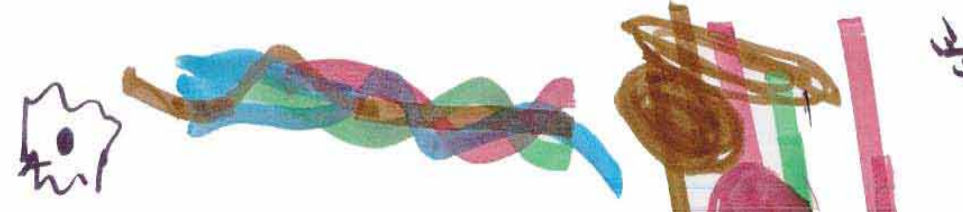

"DUWAMISH ENGINE"
DRIVING CHANGE
& ENERGY PROGRAM
"UPPER" PARTS SYSTEM



INTER-LOOKING

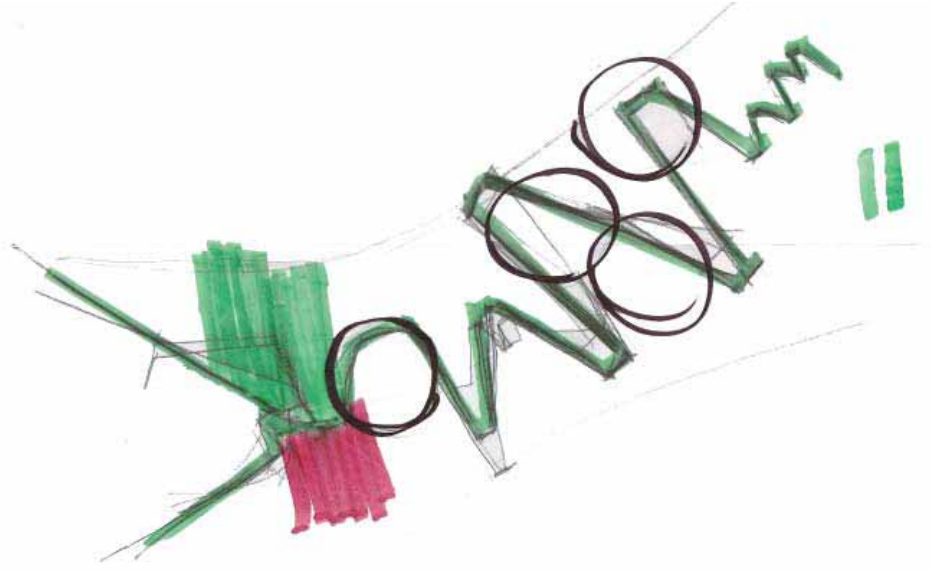

THE DUWAMISH ZIPPER"

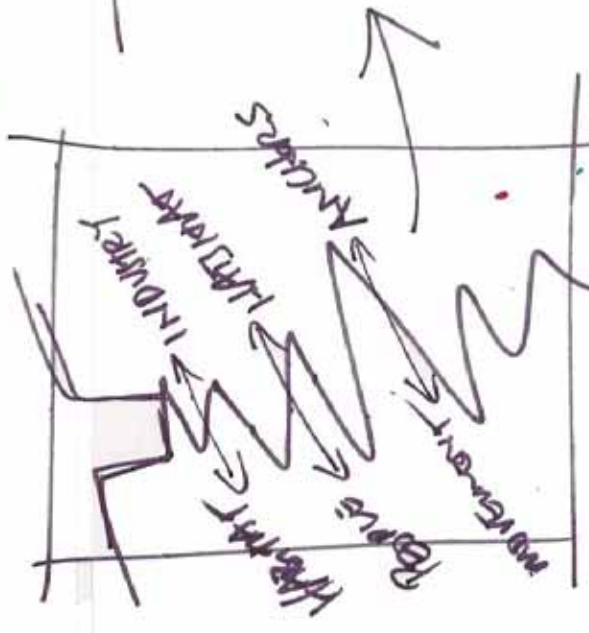

WEAVING
THE TOP OF THE
"SKIRT" FROM
THE FABRIC

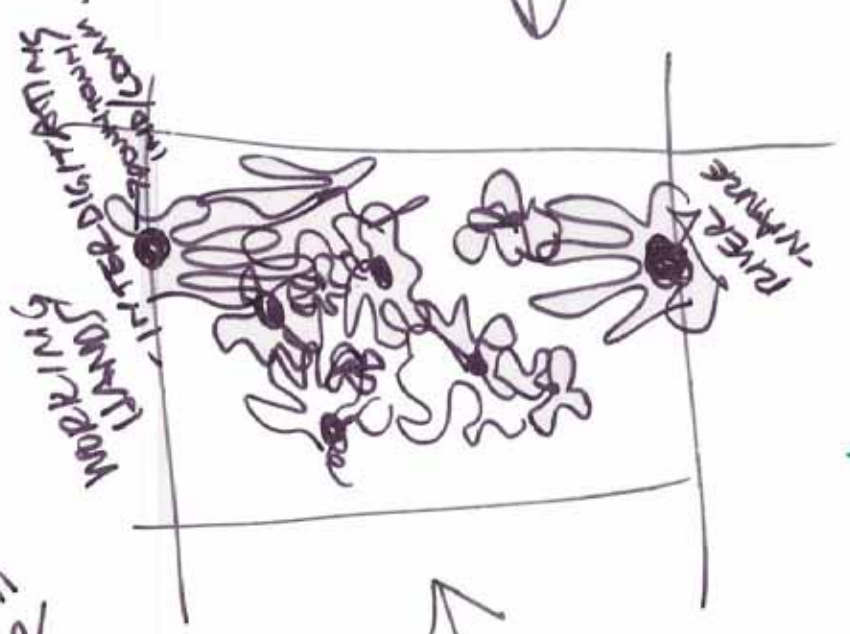

"THINKING LOCAL"

STRENGTH RAISED
IN LOCALY-FOCUSED
DEVELOPMENT

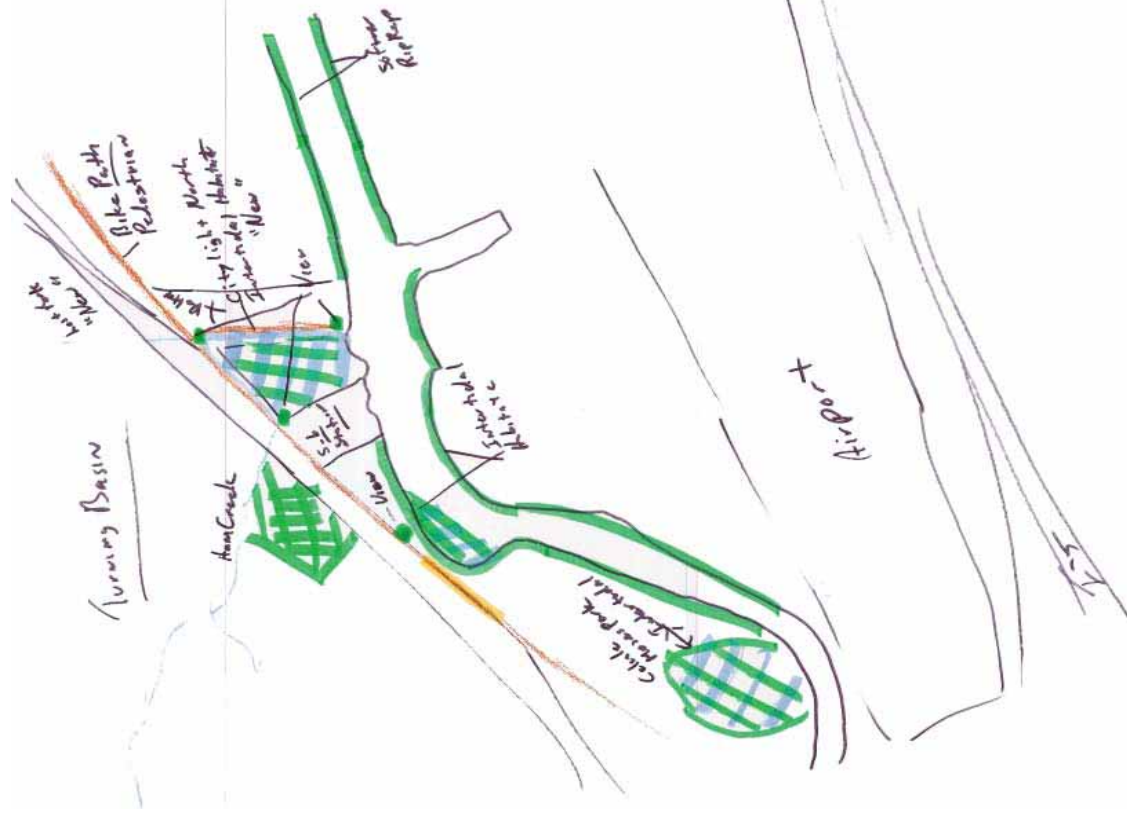

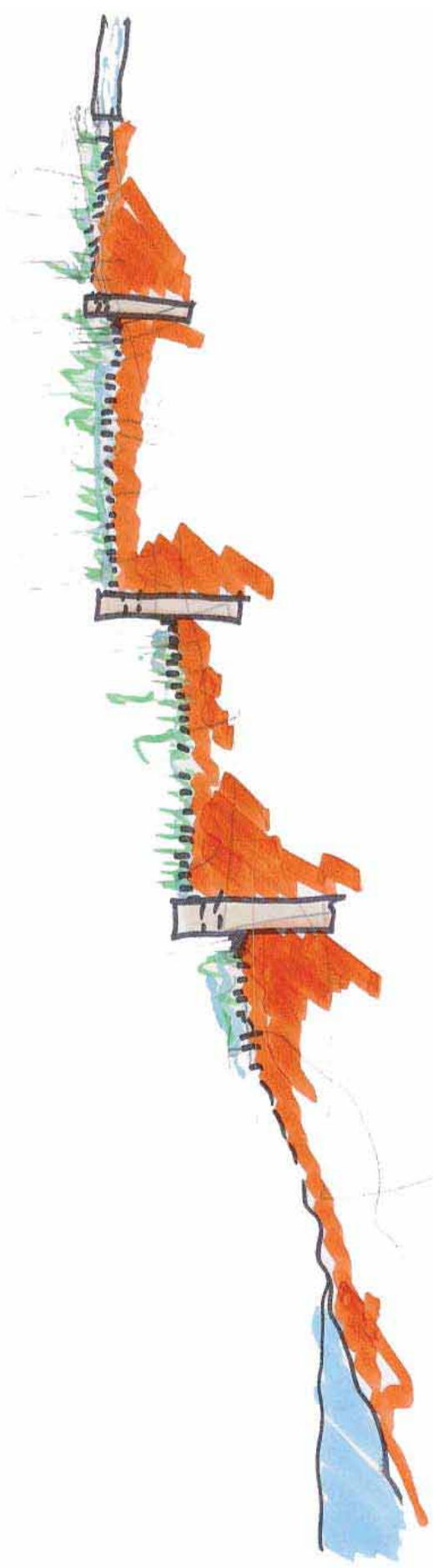

WATER TREATMENT TERRACES

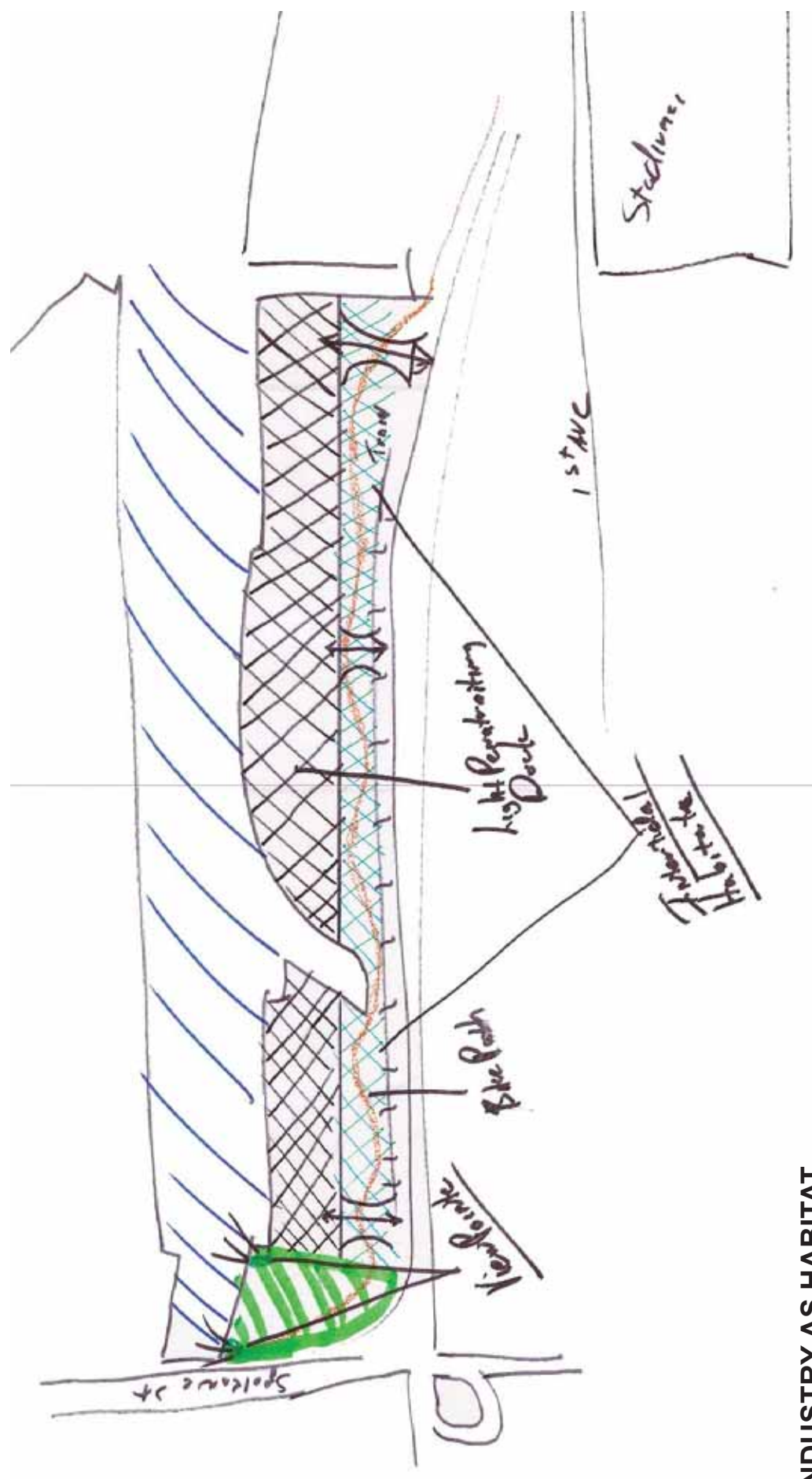

INDUSTRY AS HABITAT



SOUTH PARK & GEORGETOWN

OPEN SPACE 2100 - DUWAMISH TEAM: PROCESS PLANS - BOEING AREA

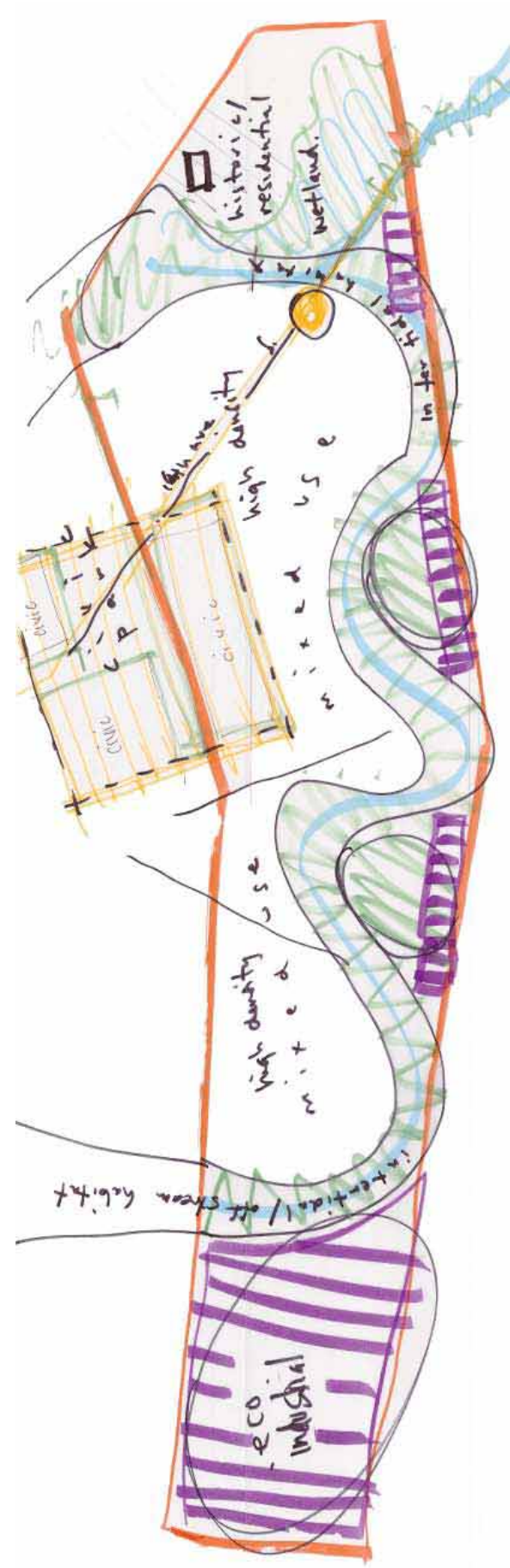
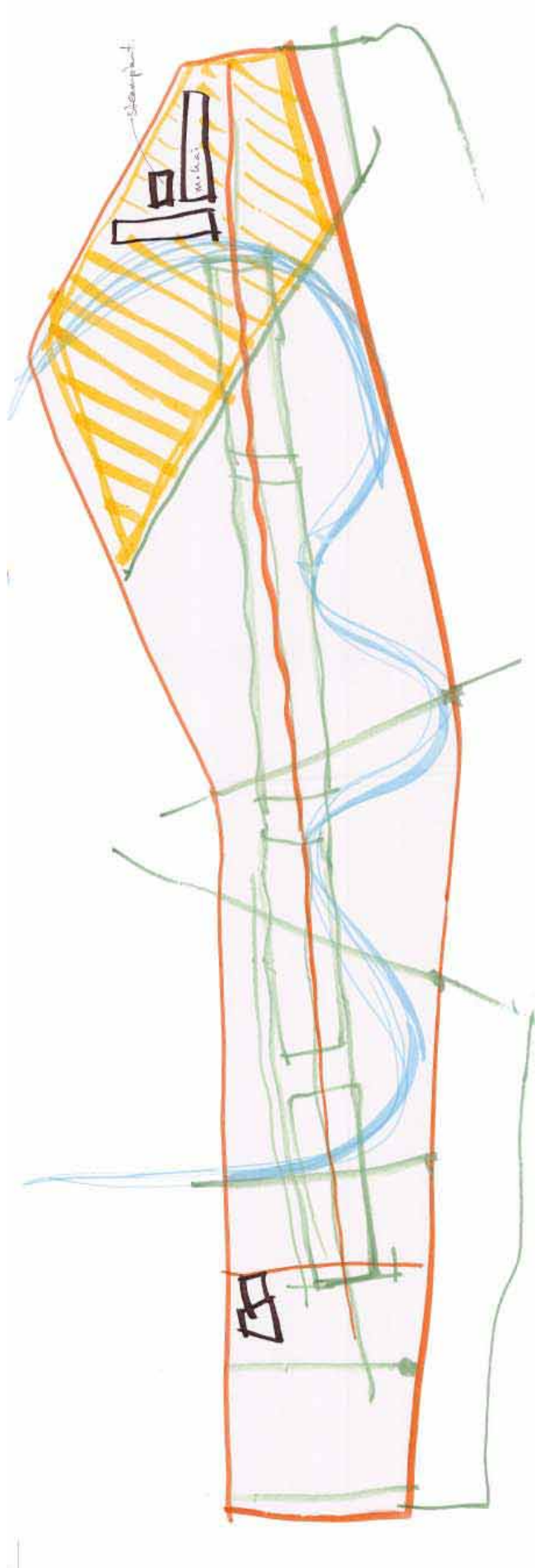
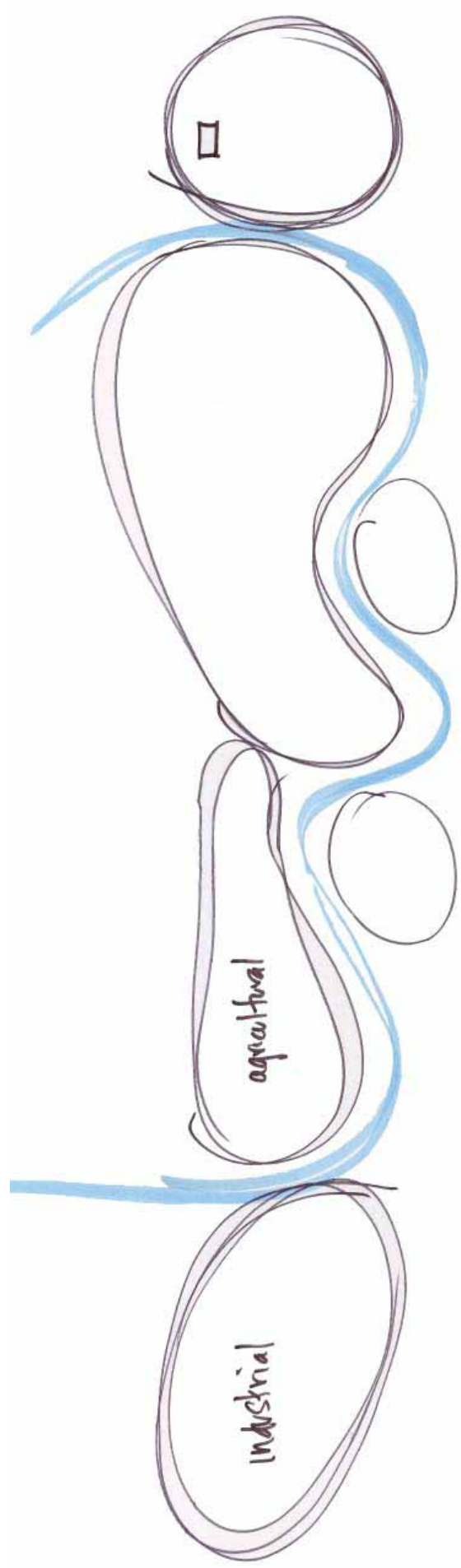



OPEN SPACE 2100 - DUWAMISH TEAM: PROCESS PLAN - STUDY AREA

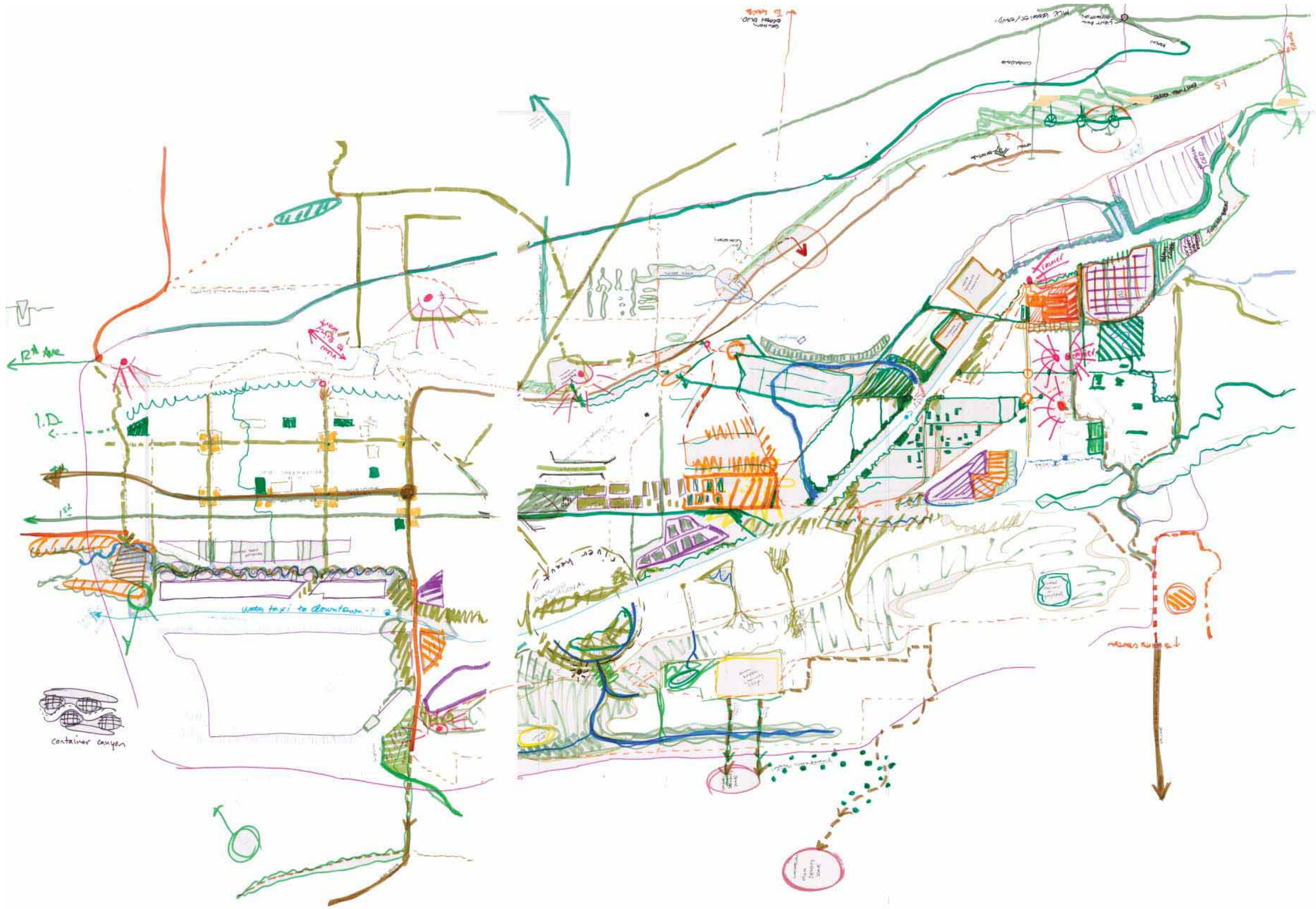



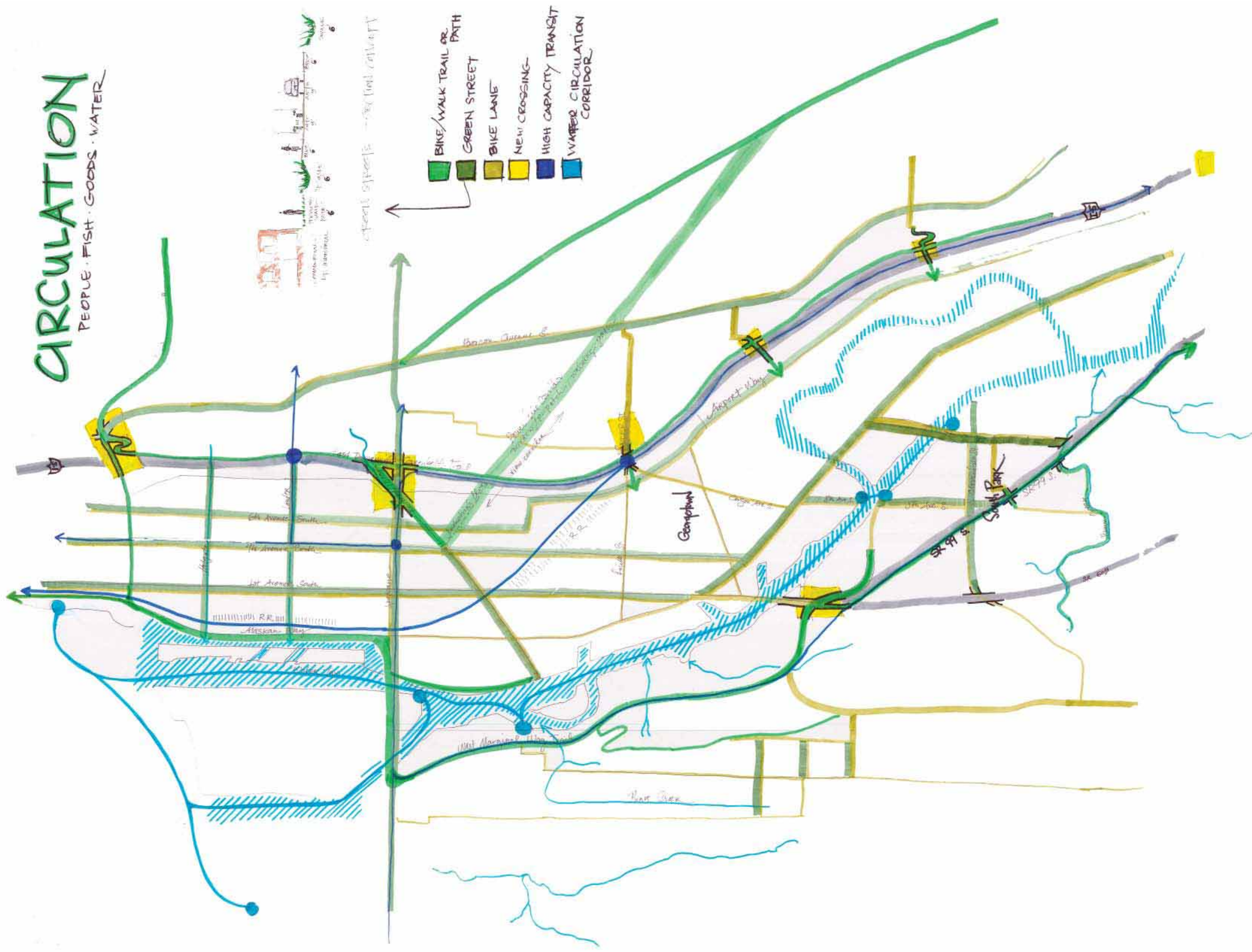

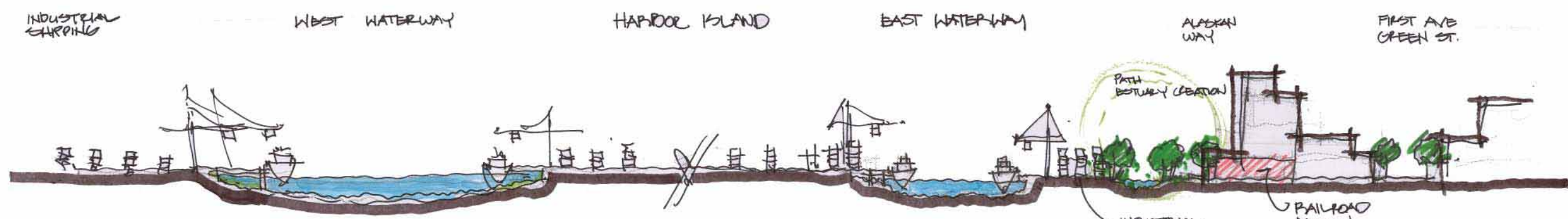

RIVER MOUTH AREA
1" = 100'



SECTION AT KELLOGG ISLAND AREA
SCALE 1" = 100'

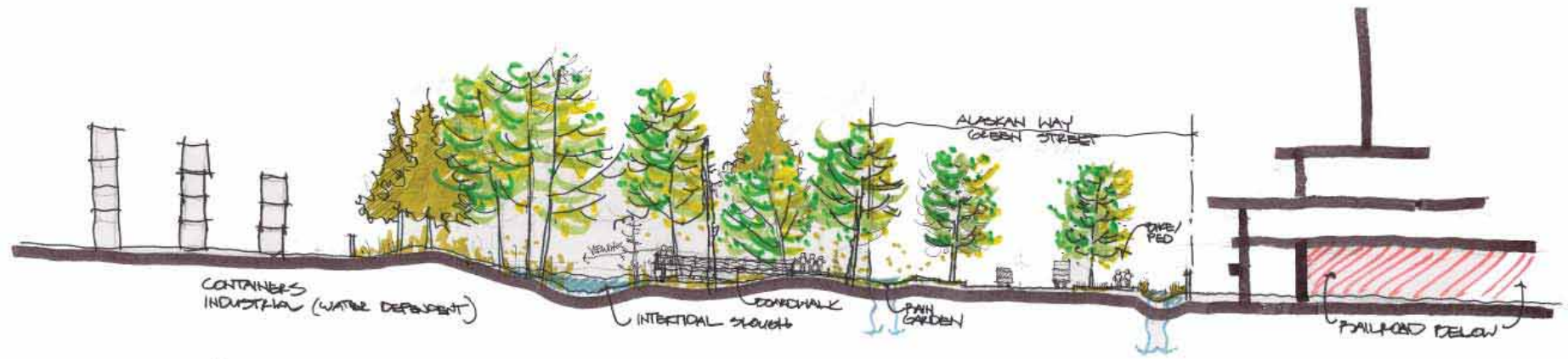

SECTION @ ALASKAN WAY CONTAINER CANYON
1" = 20'

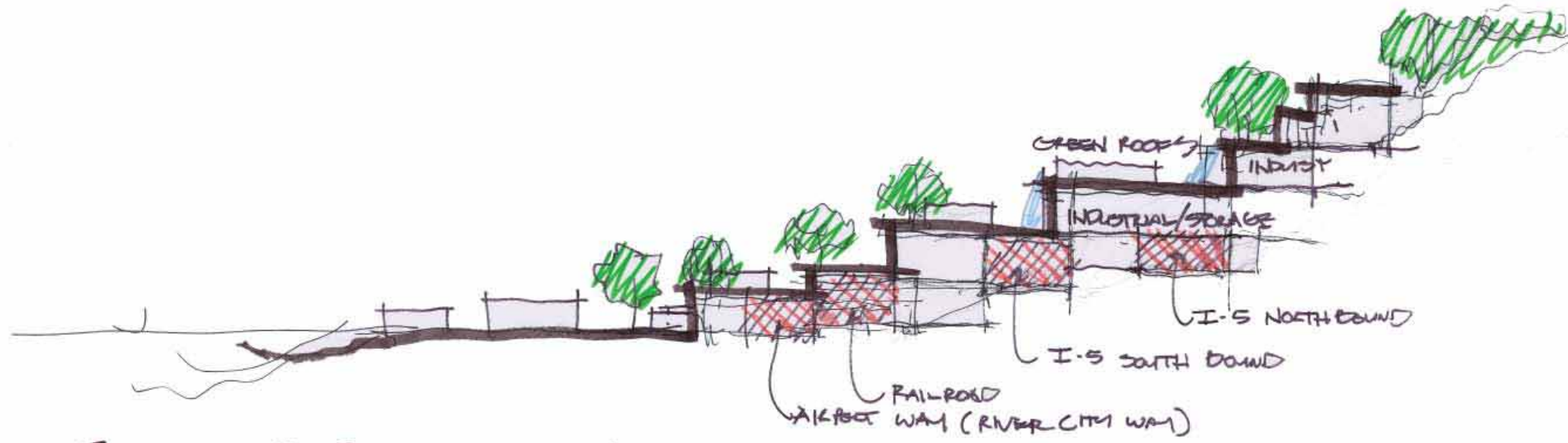

TERRACED DEVELOPMENT CONCEPT



SECTION AT NEW CHANNEL

1"=100'

OPEN SPACE 2100 - DUWAMISH TEAM: CROSS SECTIONS

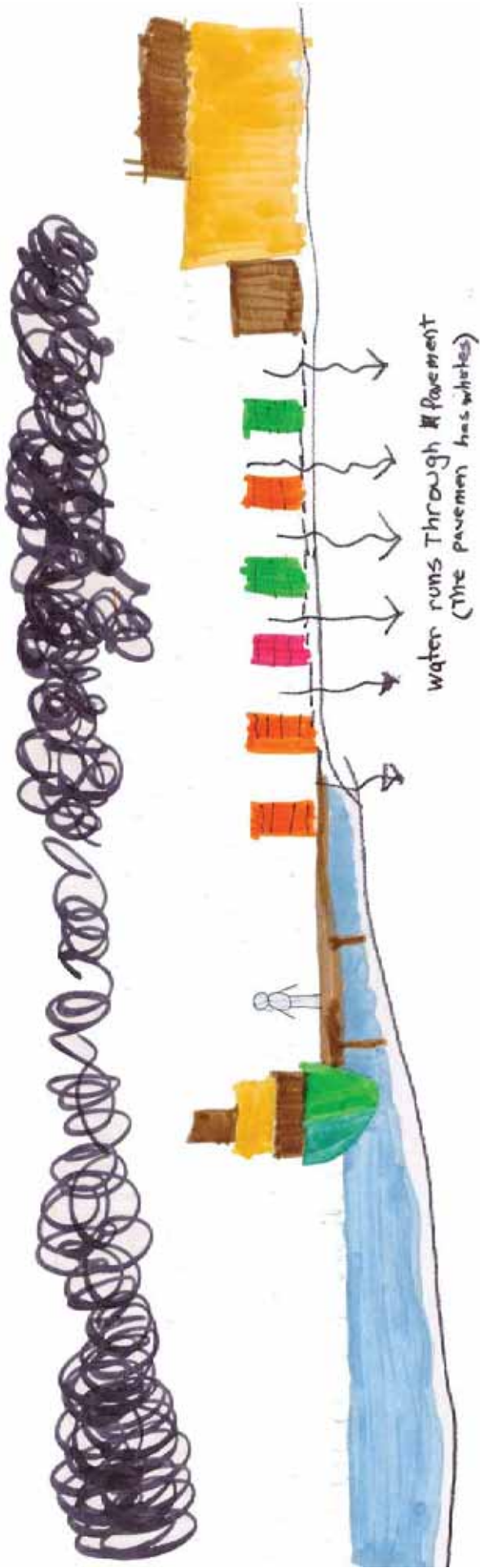

by sb

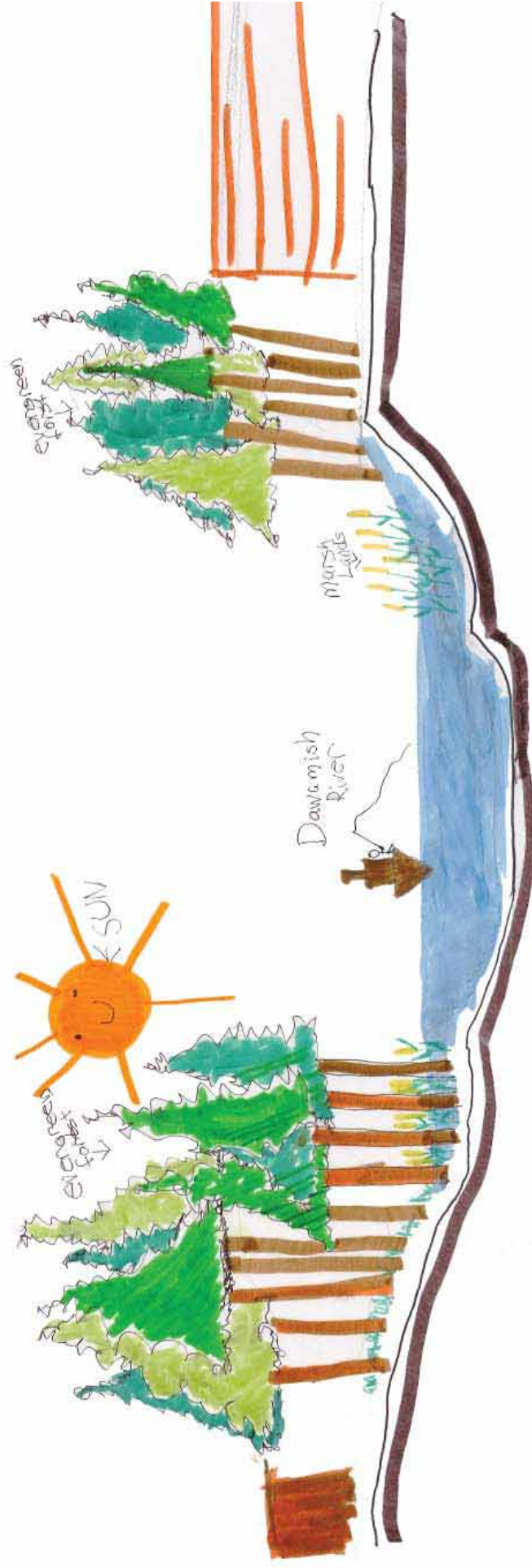

OPEN SPACE 2100 - DUWAMISH TEAM: CONCEPT

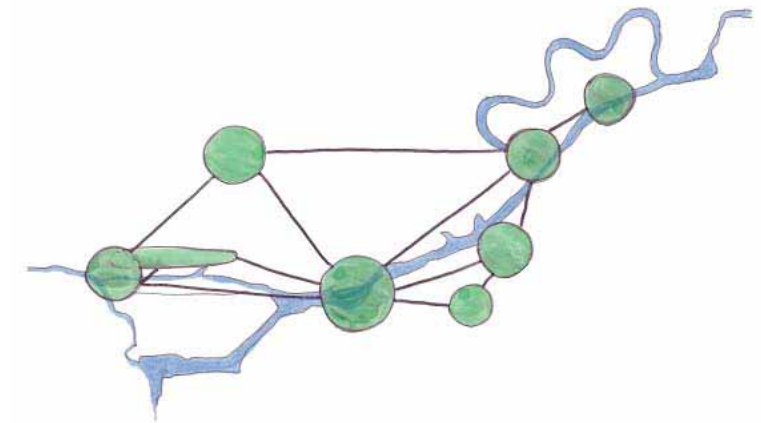

GREENSPACE

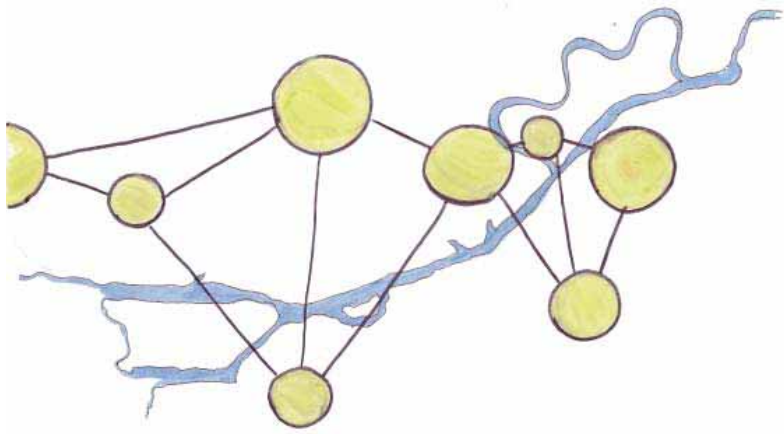

URBAN VILLAGES

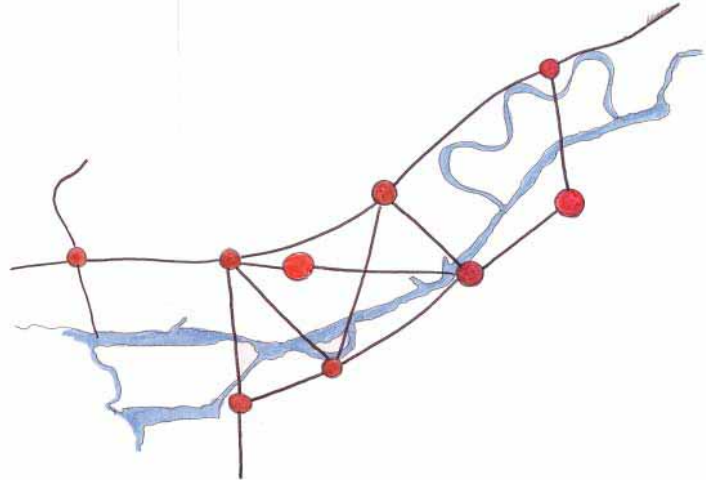

TRANSPORTATION

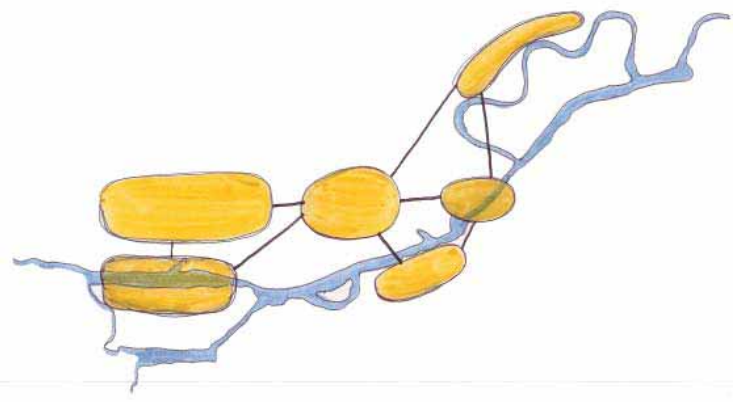

INDUSTRY

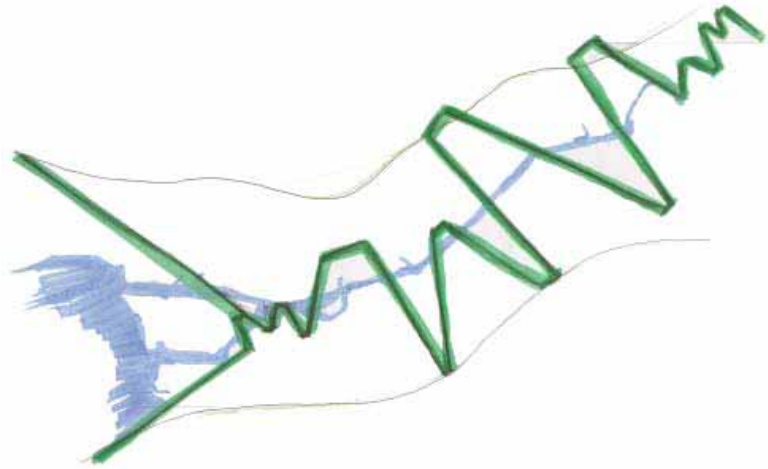

ZIPPER

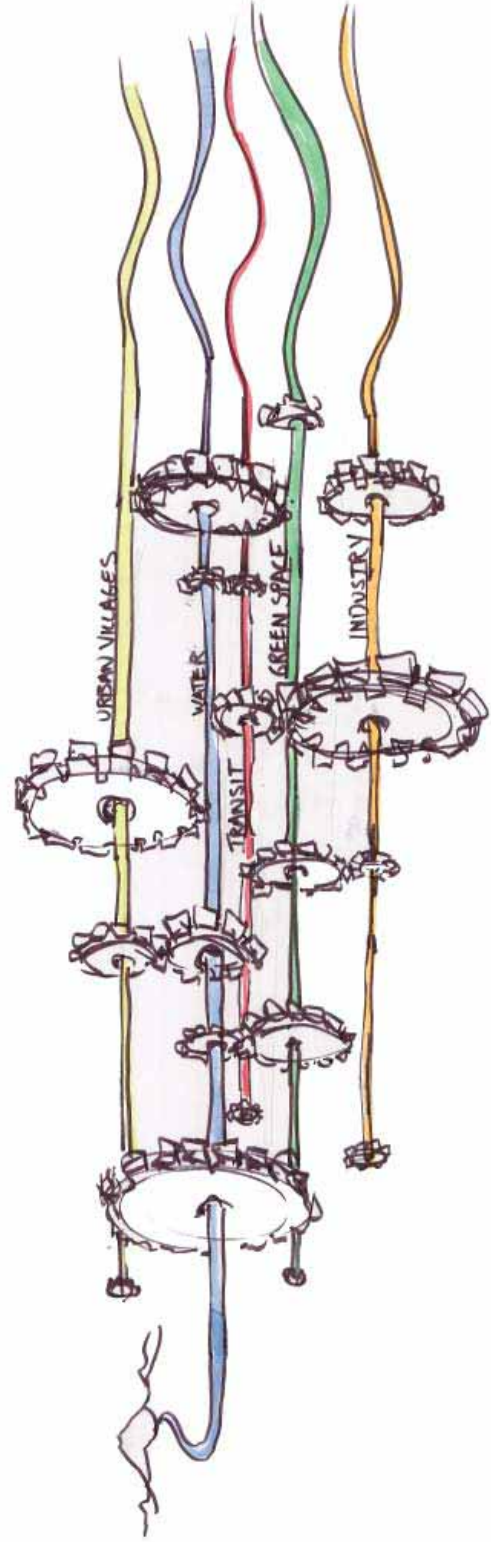

MACHINE

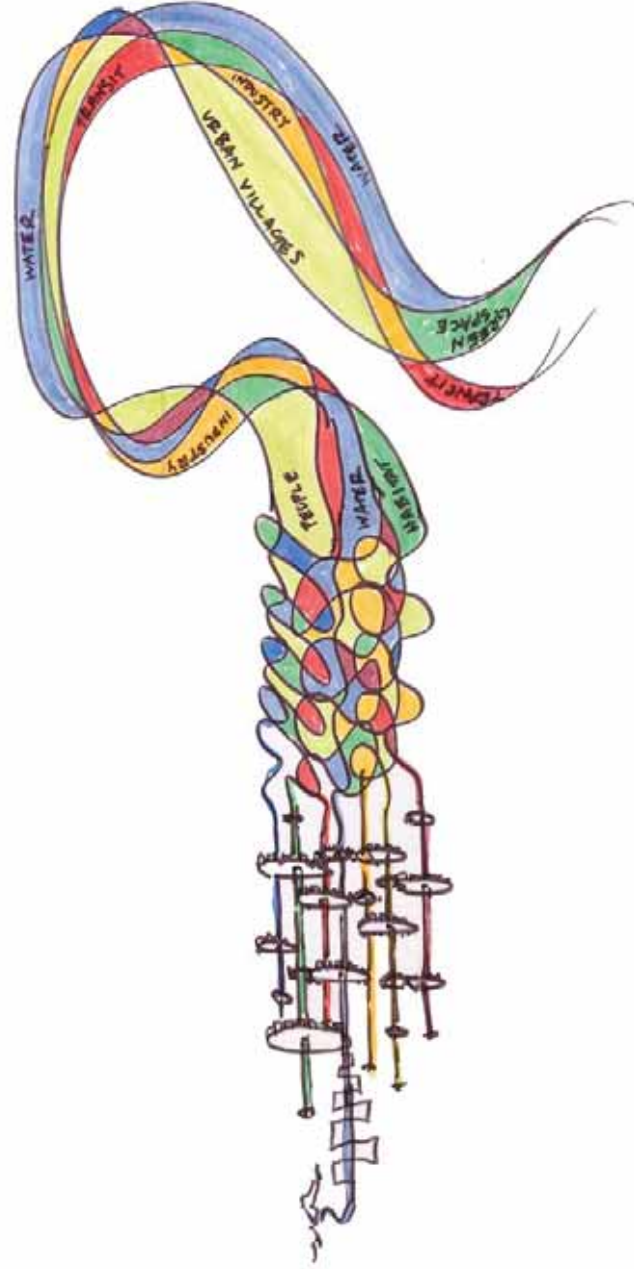

LOOM