

stone way: celebrate! a stream restored, a neighborhood connected

2026

assumptions

- People travel by automobile for a majority of trips but significant mode shifts have occurred.
- Fuel used for automobiles is non-polluting and is increasingly expensive.
- Densities in Wallingford and Fremont are increasing.

scenario

- The amount of road space designated for automobiles is reduced to two lanes of traffic and one lane for parking
- Two grade-separated bike lanes allow Stone Way to become a key north/south bicycle route
- Vegetated swales filter and treat stormwater going to Lake Union
- All surfaces are permeable including permeable pavement on sidewalks and roads

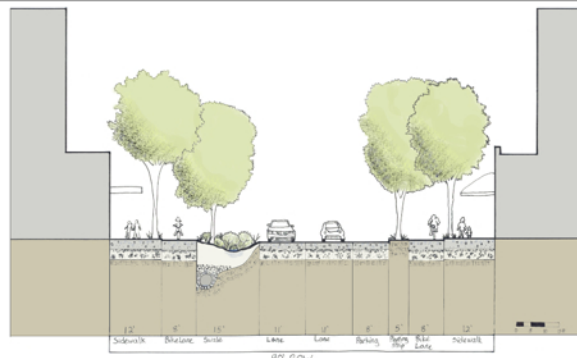

connect

- urban villages • wallingford to fremont
- parks • woodland park to waterfall park and gas works park
- water • filtering swales to stoneway creek to lake union

restore

- stoneway creek • ecological function and natural habitat
- lake union • green shoreline and clean runoff

celebrate

- water • visual celebration of increasingly scarce resource
- people • linear park as community gathering space

stone way daylighted stream corridor

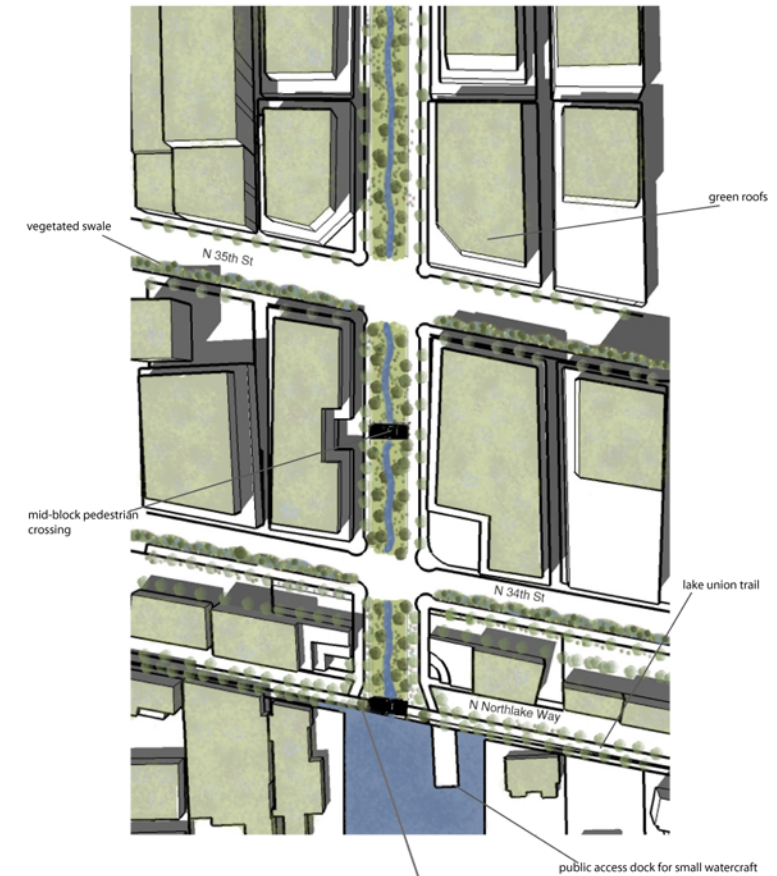

2056

assumptions

- Automobiles are used less frequently because of improved transit like the streetcar and light rail
- Automobiles are significantly smaller due to increasing fuel prices
- More attention is paid to water quality as the scarcity of this resource is beginning to be realized
- Stone Way is a main commercial corridor with high density mixed-use development

scenario

- The use of skinny cars allows lanes to become narrower so less right-of-way is designated for automobile use
- The historic stream is daylighted and habitat restoration has begun

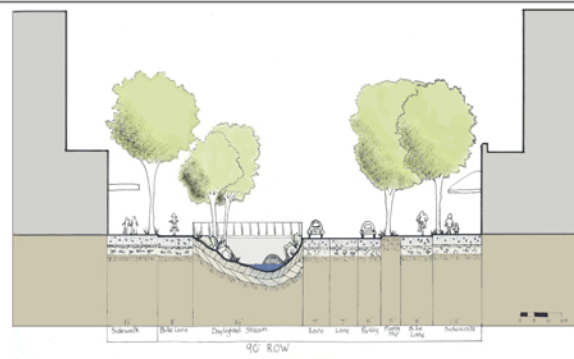

concept

By 2106, Stone Way will serve as a spine connecting neighborhoods and open spaces. The right-of-way currently dedicated to automobiles will be dedicated to a daylighted stream, pedestrians and bicycles. Stone Way will function as an ecologically healthy stream as well as a connector for pedestrians and bikers. Vegetated swales will line the streets intersecting Stone Way, allowing clean water to flow into the stream. A streetcar will run along N 35th St and provide east/west connections. Wa



2106

assumptions

- Automobiles are used sparingly due to high fuel costs and efficient alternatives
- Public transit, biking, and walking are the primary form of transportation
- Increased densities create a high demand for open space and connections to nature
- Extreme weather events are more common due to global warming

scenario

- All lanes for automobile traffic are removed from Stone Way
- The restored stream has improved habitat
- Filtering swales are added to both sides of the stream to filter sediment and prevent negative environmental impacts of extreme storm events

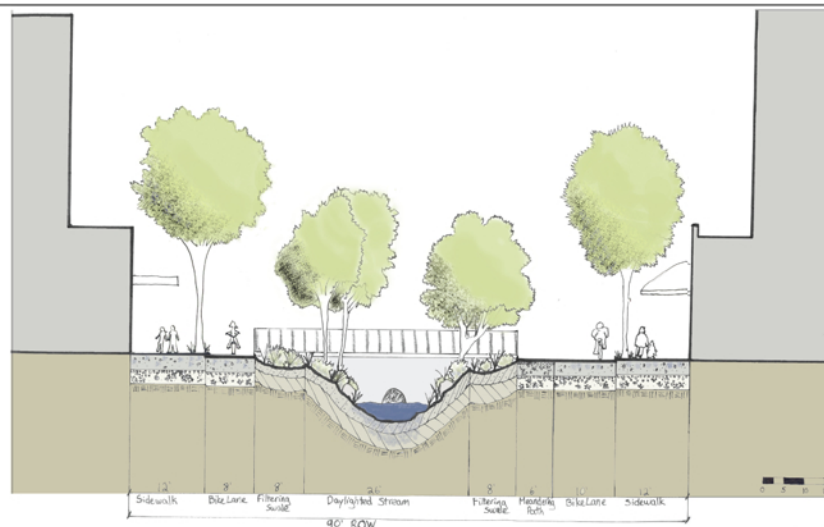

stone way street-end: waterfall park

