

Lyceum

| | | | |
|--|-----------------------------------|---------------|---------------------|
| Department/Organization -- | Event Name -- | Res # -- | Event Date(s) -- |
| A/V & Equipment Contact our office for more information | Setup Notes Open space for 396 | | |
| | File Saved As LYC_OS.396 | Version -- | Date Updated -- |

Standard Set
Open Space, Stacks of Chairs

Max Capacities
Lecture - 396
Banquet - 224
Exhibit - 41 Tables
Classroom - 144
Seminar - 150

Scale
1 inch = 12 feet

Area
Square Feet
3,339

Built-In AV (rental fees may apply)
House PA* (up to 4 wired mics included), Computer Audio Cable, Data Projector w/Screen, Performance Lighting
*Performance Level PA available
All AV must be requested in advance.

Contact
HUB Event & Information Services
Box 352230
(206)543.8191
hubres@uw.edu
http://depts.washington.edu/thehub/

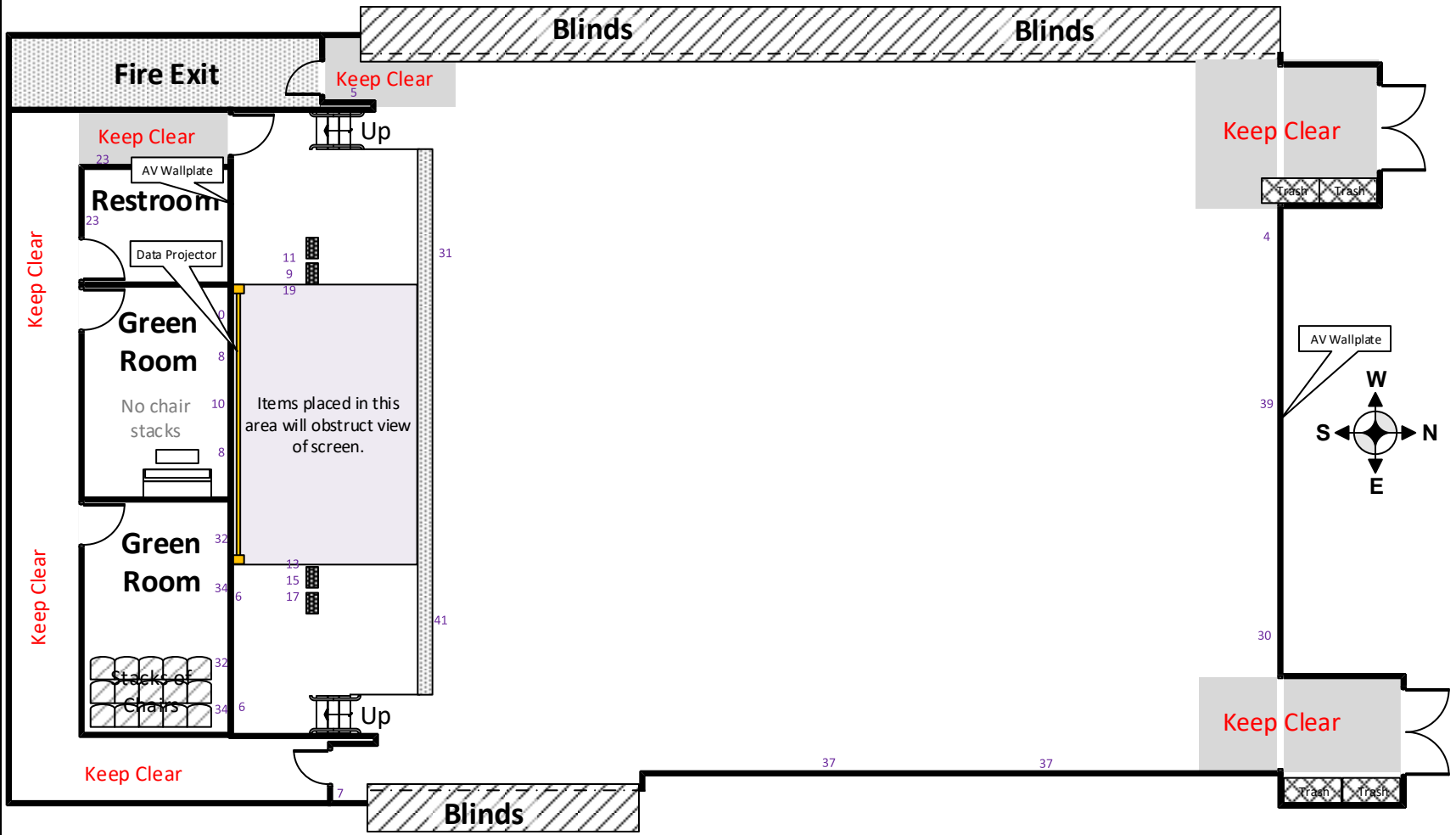

All components of the diagrams are subject to change. Illustrated diagrams and their components are estimations only. Additional furnishings (stacks of chairs/tables) not indicated on the diagram may be present in the room at the time of your reservation. Please contact our office with any additional questions.

Please sign below and return by listed due date on your confirmation. Only first contact's signature will be accepted.

Signature: _____ Date: _____

By signing this diagram, you agree to this setup. Changes on the day of event MAY not be possible.
All exits and hallways must remain clear and unblocked.