

WASHINGTON PARK ARBORETUM

PACIFIC CONNECTIONS GARDENS PHASE II

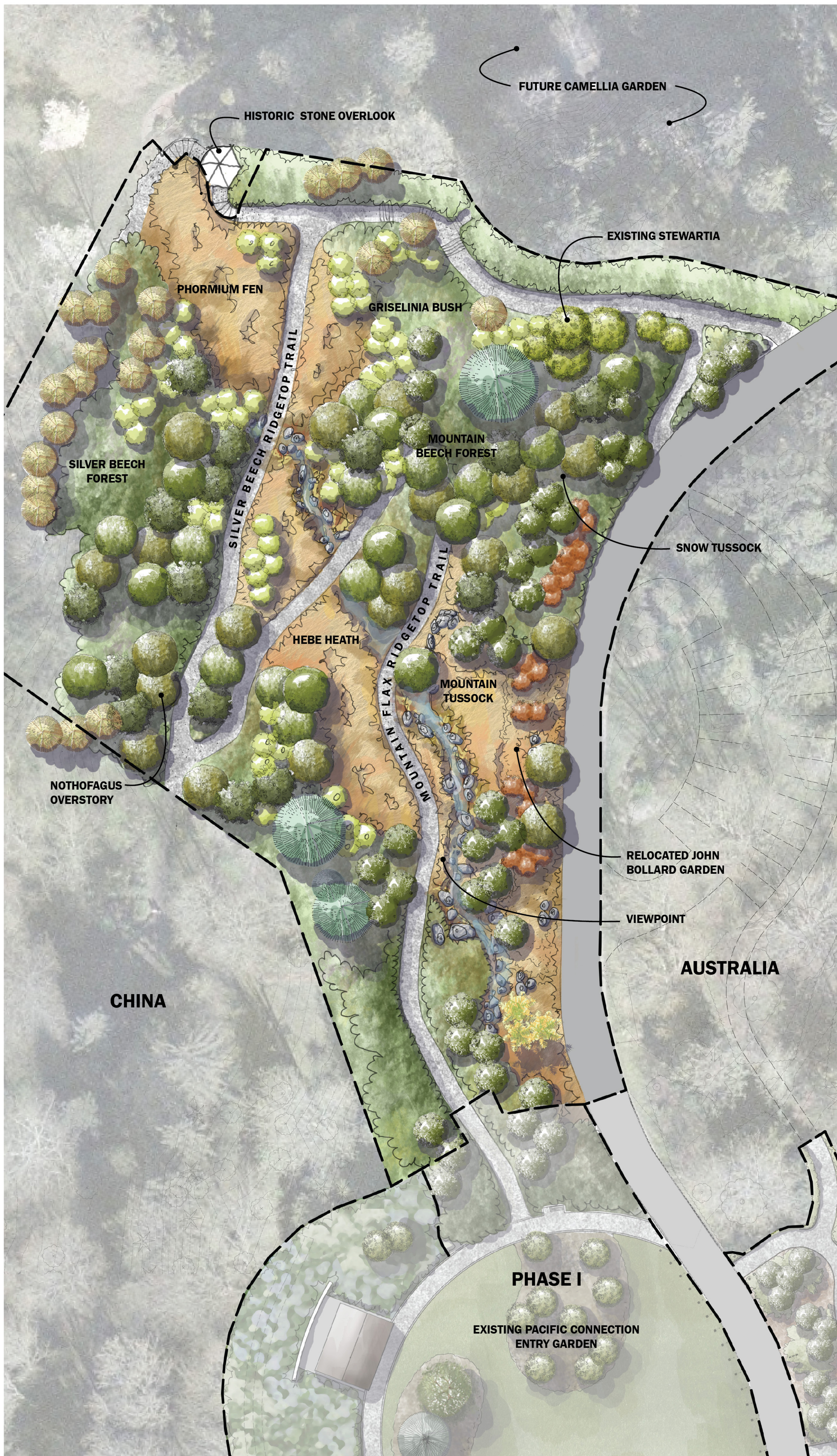

SELECTED PLANT LIST:

- Coprosma ciliata*
- Hoheria angustifolia*
(Narrow-leaved Lacebark)
- Hoheria populnea*
(Lacebark)
- Hoheria sexstylosa*
(Ribbonwood)
- Leptospermum scoparium*
(Tea Tree)
- Libocedrus plumosa*
(New Zealand Cedar)
- Nothofagus menziesii*
(Silver Beech)
- Nothofagus solandri*
var. *cliffortioides*
(New Zealand Black Beech)
- Pittosporum eugenioides*
(Lemonwood)
- Pseudopanax laetus*
- Carex albula*
(Frosty Curl Sedge)
- Carex buechananii*
(Leather-leaf Sedge)
- Carex flagellifera*
(Toffee Twist Sedge)
- Carex testacea*
(Orange New Zealand Sedge)
- Chionochloa conspicua*
(Plumed Tussock)
- Chionochloa flavicans*
(Snow Tussock)
- Fuchsia procumbens*
(Creeping Fuschia)
- Hebe* sp.
(Hebe)
- Lepidothamnus laxifolius*
(Pygmy Pine)
- Olearia paniculata*
(Akiraho)
- Phormium cookianum*
(Mountain Flax)
- Pittosporum tenuifolium*
(Kohuhu)
- Pseudowintera axillaris*
(Pepper Bush)
- Ranunculus lyallii*
(Mountain Buttercup)
- Griselinia littoralis*

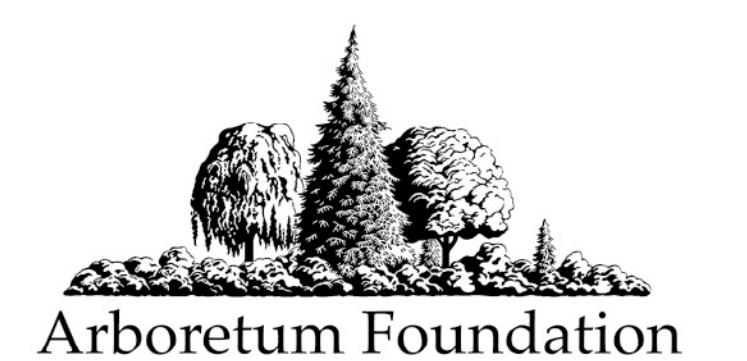

NEW ZEALAND FOREST