

PLANT LIST

BED A

- 1 *Hamamelis x intermedia* 'Ruby Glow'
- 2 *Helleborus foetidus*
- 3 *Hamamelis x intermedia* 'Orange Beauty'
- 4 *Carex buchananii*
- 5 *Pulmonaria* sp.
- 6 *Sarcococca hookeriana* var. *digyna*
- 7 *Mahonia x media* 'Lionel Fortescue'
- 8 *Rhododendron* 'Seta'
- 9 *R. dauricum*
- 10 *R.* 'Anchorite'
- 11 *R.* 'Saunders Beauty'
- 12 *Corylopsis sinensis* 'Spring Purple'
- 13 *Ribes laurifolium*
- 14 *Mahonia* 'Arthur Menzies'
- 15 *Hamamelis x intermedia* 'Westerstede'
- 16 *Rhododendron cyanocarpum*

BED B

- 1 *Helleborus x hybridus*
- 2 *Hamamelis x intermedia* 'Pallida'
- 3 *Berberis x gladwynensis* 'William Penn'
- 4 *Bergenia cordifolia* 'Rotblum'
- 5 *Rhododendron* 'Cilpinense'
- 6 ...
- 7 *Calluna vulgaris* 'Robert Chapman'
- 8 *Osmanthus heterophyllus* 'Goshiki'
- 9 *Erica x darleyensis* 'Silberschmelze'
- 10 *Hydrangea anomala* ssp. *petiolaris*
- 11 *Garrya elliptica* 'Evie'
- 12 *Garrya x issaquahensis*
- 13 *Cornus stolonifera* 'Kelsey's Dwarf'
- 14 *Lonicera standishii*
- 15 *L. fragrantissima*
- 16 *Azara microphylla*
- 17 *Mahonia* 'Arthur Menzies'
- 18 *Helleborus argutifolius*

BED C

- 1 *Ophiopogon planiscapus* 'Ebony Knight'
- 2 *Chimonanthus praecox*
- 3 *Iris foetidissima*
- 4 *Carex morrowii* 'Variegata'
- 5 *Cornus sanguinea* 'Midwinter Fire'
- 6 *Salix gilgiana*
- 7 *Callicarpa japonica*
- 8 *S. irrorata*
- 9 *S. alba* 'Vittellina'
- 10 *Ilex verticillata* 'Afterglow'
- 11 *Cornus stolonifera* 'Flaviramea'
- 12 *S. acutifolia* 'Pendulifolia'
- 13 *S. melanostachys*

BED D

- 1 *Erica x darleyensis* cultivars
- 2 *Acer palmatum* 'Sango-kaku'
- 3 *A. griseum*
- 4 *Helleborus x hybridus*
- 5 *Betula albo-sinensis* var. *septentrionalis*
- 6 *Brachyglottis* 'Sunshine'

BED E

- 1 *Rhododendron arboreum* hybrid
- 2 *Helleborus x hybridus*
- 3 *Osmanthus heterophyllus* 'Variegatus'
- 4 *Abeliophyllum distichum*
- 5 *Acer palmatum* 'Matsumurae'

BED F

- 1 *Calluna vulgaris* 'Gold Haze'
- 2 *Rhododendron* 'Cilpinense'
- 3 *Magnolia stellata* 'Rosea'
- 4 *E. x darleyensis* 'Silberschmelze'
- 5 *Corylus avellana* 'Contorta'
- 6 *Calluna vulgaris* 'Robert Chapman'

BED H

- 1 *Acer palmatum* 'Murogawa'
- 2 *A. p.* 'Omurayama'
- 3 *Callicarpa dichotoma*
- 4 *C. bodinieri* var. *giraldii* 'Profusion'
- 5 *Corylus maxima* 'Atropurpurea Superba'
- 6 *Daphne mezereum*
- 7 *Rhododendron* 'Cilpinense'
- 8 *Viburnum x bodnantense* 'Dawn'
- 9 *Ulmus americana*
- 10 *Acer palmatum* 'Japanese Sunrise'
- 11 *Photinia (Stranvaesia) davidiana* var. *undulata*
- 12 *Corylopsis pauciflora*
- 13 *C. spicata*
- 14 *R. mucronulatum* 'Cornell Pink'
- 15 *R. lutescens*
- 16 *R. ririei*
- 17 *Helleborus x hybridus*

BED I

- 1 *Rhododendron strigillosum*
- 2 *Ilex verticillata* 'Red Sprite'
- 3 *Ilex aquifolium* 'Madame Briot'
- 4 *Ilex x altaclerensis* 'Eldridge'
- 5 *Aucuba japonica* 'Picturata'
- 6 *Elaeagnus pungens* 'Maculata'

BED K

- 1 *Hamamelis japonica* var. *flavopurpureascens*
- 2 *Sarcococca hookeriana* var. *digyna*
- 3 *Viburnum tinus* 'Lucidum'
- 4 *V. foetens*
- 5 *Camellia sasanqua* 'Shichi Fukujin'
- 6 *C. s.* 'Mine-no-yuki'
- 7 *Stachyurus chinensis*
- 8 *Chimonanthus praecox*
- 9 *Viburnum farreri*
- 10 *V. f.* 'Nanum'
- 11 *Hamamelis japonica* var. *arborea*

- 12 *C. s.* 'Setsugekka'
- 13 *Camellia sasanqua*
- 14 *C. s.* 'Kokinran'

BED L

- 1 *Hebe* 'Coed'
- 2 *Daphne mezereum* f. *alba*
- 3 *Berberis wilsoniae*
- 4 *Polystichum polyblephorum*
- 5 *Viburnum tinus* 'Pink Prelude'
- 6 *Iris foetidus*
- 7 *Sarcococca confusa*
- 8 *S. hookeriana* var. *digyna*
- 9 *Mahonia* 'Arthur Menzies'
- 10 *Ruscus aculeatus*
- 11 *Camellia x williamsii* 'Stryker 50-1-3'
- 12 *C.* 'Wabisuke'
- 13 *C. pitardii* 'Apple Blossom'
- 14 *C. x w.* 'Mary Christian'
- 15 *C. sasanqua*
- 16 *C. sp.*

BED M

- 1 *Pieris japonica* 'Mountain Fire'
- 2 *Hamamelis mollis*
- 3 *Sarcococca hookeriana* var. *digyna*
- 4 *Hamamelis x intermedia* 'Hiltingbury'
- 5 *Jasminum nudiflorum*
- 6 *Hamamelis x intermedia* 'Jelena'
- 7 *Picea mariana* 'Nana'
- 8 *Liriope muscari* 'Big Blue'
- 9 *Cyclamen coum*
- 10 *Stewartia monadelpha*
- 11 *Gaultheria (Pernettya) mucronata*
- 12 *Garrya x issaquahensis* 'Carl English'
- 13 *Camellia sasanqua* 'Hinode-gumo'
- 14 *Hamamelis vernalis*
- 15 *Daphne odora* 'Aureomarginata'
- 16 *Mahonia x media* 'Winter Sun'
- 17 *Sarcococca hookeriana* var. *humilis*
- 18 *X Fatschedera lizei*
- 19 *Sarcococca confusa*
- 20 *Camellia x lutchuensis* 'Ack-Sno'
- 21 *C. x lutchuensis* 'Ack-White'
- 22 *C. x lutchuensis* 'Ack-Star'

BED O



- 1 *Epimedium x perralchicum*
- 2 *Mahonia* 'Arthur Menzies'
- 3 *Leucothoe fontanesiana* 'Rainbow'
- 4 *Polystichum setiferum* 'Rotundatum Cristatum'
- 5 *Rhododendron barbatum*
- 6 *Hamamelis x intermedia* 'Winter Beauty'

KAEMPFERI BED

- 1 *Hamamelis x intermedia* 'Fire Charm'
- 2 *H. mollis* 'Gold Crest'
- 3 *Cornus oblonga*
- 4 *Corylopsis gotoana*
- 5 *Corylopsis glabrescens*
- 6 *Rehderodendron macrocarpum*

WASHINGTON PARK ARBORETUM

JOSEPH A. WITT WINTER GARDEN

 Tree from the plant list
 Large conifer, not listed

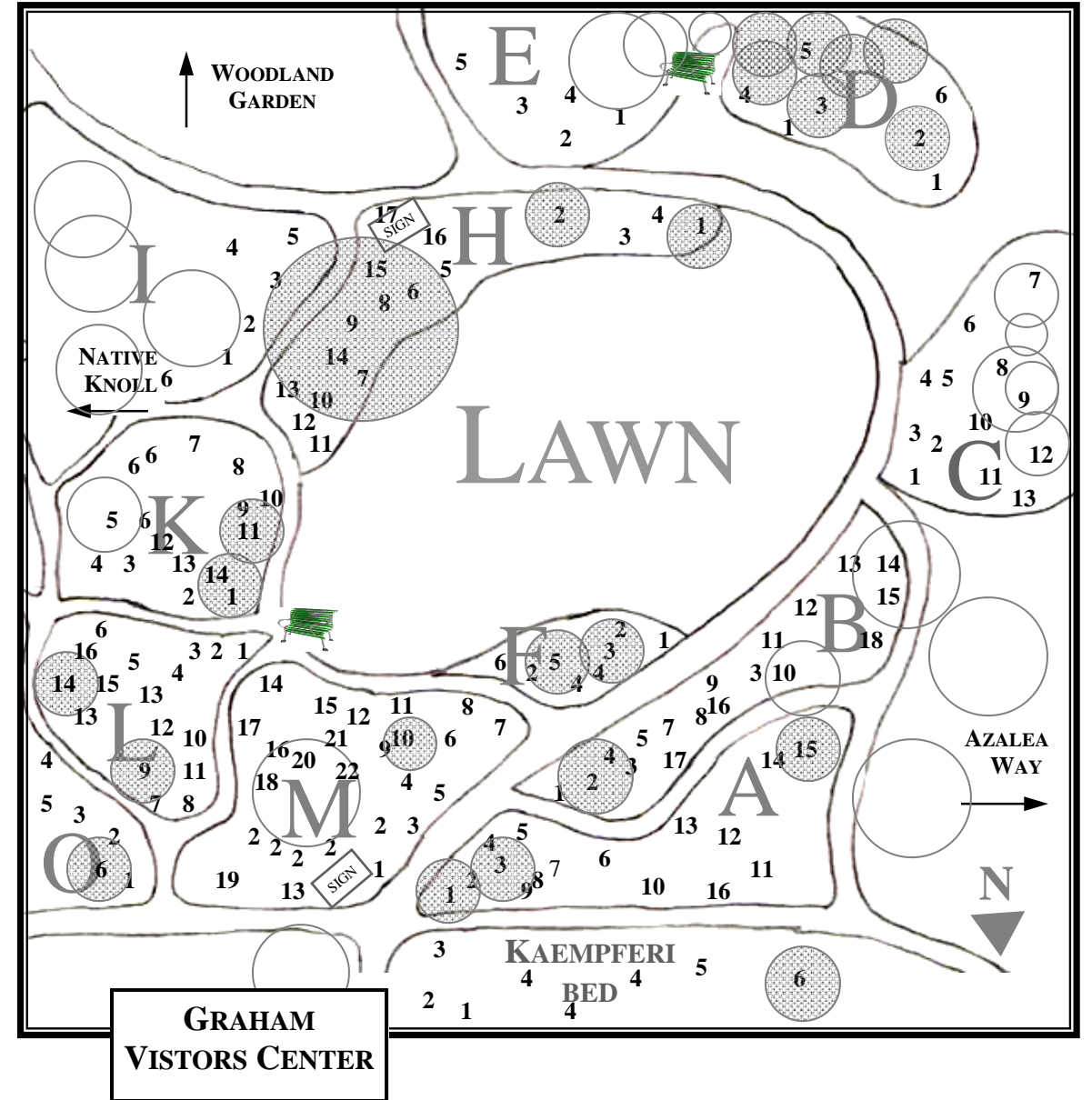

WINTER GARDEN TOUR

BED A Featured plants of this bed include Witch Hazel (*Hamamelis*), and later blooming Winter Hazel (*Corylopsis*). The pendant butter yellow flowers of *Corylopsis* decorate this wide growing shrub. *C. sinensis* ‘Spring Purple’ sports five inch flowers and bronze new growth. The light green flowering *Helleborus foetidus* makes a perfect evergreen understory.

BED B *Azara microphylla* adds an interesting element to the evergreen backdrop of Bed B. The lacy, tiny green leafed tree has tinier yellow flowers that smell like white chocolate. Evergreen Silk-Tassel (*Garrya*) grows in the foreground where its elegant vertical tassels can be appreciated. You’ll notice an assortment of *Garrya* varieties with slightly varying features in the garden. Don’t miss the fruity fragrance of the Winter Honeysuckle (*Lonicera standishii*) shrubs at the south end of this bed. These and the *Mahonia* species attract our year-round resident, Anna’s Hummingbird.

BED C Colorful stems provide the theme of this bed. *Cornus sanguinea* ‘Midwinter Fire’ blazes orange, Willows (*Salix*) add to the mix. Black Mondo Grass (*Ophiopogon planiscapus* ‘Ebony Knight’) carpets the bed beneath the Yellow Twig Dogwood (*Cornus stolonifera* ‘Flaviramea’). The native evergreen backdrop shows off delicate Wintersweet (*Chimonanthus praecox*) blossoms. These fragrant flowers are pale yellow with reddish centers.

BED D Bark is the highlight of this bed. The Birches (*Betula albosinensis* var. *septentrionalis*) just might be the most striking trees in this garden. Their peeling, bright pinkish-white bark as well as their placement in the garden make them top contenders. This is especially true when low winter sun shines on and through its bark. These *Betulas* share the spotlight with the Paper Bark Maple (*Acer griseum*), and the Coral Bark Maple (*Acer palmatum* ‘Sango-kaku’). A mixture of Heath species (*Erica*) and Hellebores (*Helleborus x hybridus*) provide evergreen interest and flowers below the trees.

BED E One plant of interest is the sparkly *Osmanthus heterophyllus* ‘Variegatus’. It looks like a Holly but it isn’t a Holly at all. The White Flowering Forsythia (*Abeliophyllum distichum*) also has a misleading “common name.”

BED F The dominant features of Bed F include those of Harry Lauder’s Walking Stick (*Corylus avellana* ‘Contorta’) with its curly twigs and straight vertical tassels, as well as the fuzzy winter buds and pink flowers of the *Magnolia stellata* ‘Rosea’.

BED H Together, Japanese Maples (*Acer palmatum*) and the grand American Elm (*Ulmus americana*) create a canopy that leads to the wide open “woodland room” of the Winter Garden. Beneath

the Elm blooms a very fragrant group of the deciduous *Viburnum bodnantense* ‘Dawn’. Gorgeous red berries grace the low growing *Photinia* (*Stranvaesia*) *davidiana* var. *undulata*. A Coral Bark Japanese Maple (*Acer palmatum* ‘Japanese Sunrise’) has recently been planted in the north end of the bed.

BED I Variegated plants brighten this sheltered path. They are: *Aucuba japonica* ‘Picturata’, Holly (*Ilex aquifolium* ‘Madame Briot’), and *Elaeagnus pungens* ‘Maculata’.

BED K Deciduous shrubbery surrounds a beautiful grove of *Camellias*. Among them, you’ll see *C. sasanqua* ‘Kokinran’ with peppermint-striped flowers. Even more varieties of Witch Hazel (*Hamamelis*), including the stately *H. japonica* var. *arborea*, grow here. Find *Stachyurus chinensis* with its late winter creamy flowers, and another *Viburnum* species (*V. foetens*).

BED L The unusual and tiny evergreen *Ruscus aculeatus* of Bed L fame apparently has medicinal properties. *Viburnum tinus* contributes year-round beauty with long blooming white flowers, metallic blue fruit, and evergreen leaves. Some of these varieties of *Camellia* were planted in the 1950’s. They make a fabulous flowering background.

BED M Situated at the north entrance of the garden, Bed M makes a great first impression. Both fragrant Witch Hazels and the low, green stemmed Winter Blooming Jasmine (*Jasminum nudiflorum*) display yellow flowers. Bright pink *Cyclamen coum* blooms below the cinnamon bark of the Tall Stewartia (*Stewartia monadelphica*). Bark, fine structure, white flowers and deep red fall color make this tree a year round knock out. *Sarcococca* species throughout the garden offer dark, glossy green foliage and fragrant (though visually insignificant) flowers. These make a great choice for shady places.

BED O *Mahonia* ‘Arthur Menzies’ makes a bold statement all year, but its wintertime yellow flower spikes provide the icing on the cake. Just stand there a moment and you’ll likely see hummingbirds. *M.* ‘Arthur Menzies’ was selected here in the Washington Park Arboretum for its cold hardiness.

KAEMPFERI BED The early spidery flowers of the Witch Hazels (*Hamamelis*) such as *H. mollis* ‘Gold Crest’, fill the air with fragrance. Their winter flowers, structure, and fall color make them outstanding garden plants. Several varieties are strategically placed in the garden to create a canopy under which to pass before reaching the wide open space or “woodland room” in the center.

HUMMINGBIRD

For some Native American cultures, the Hummingbird is known as "Sah Sen." This tiny creature represents playfulness, friendship and good fortune. It is fortuitous to spot a Hummingbird just before major events like hunting or traveling. Since he can hover and fly backwards, he acts as a guide should anyone fall behind. Legend says that the Hummingbird puts the twinkle in the stars!

WASHINGTON PARK ARBORETUM

JOSEPH A. WITT WINTER GARDEN



Celebrate winter...

Tucked away in the deep green forest, you’ll find a “winter feast” for the senses in the Witt Winter Garden. Discover the garden’s striking colors, textures, fragrances, and structure. This little clearing contains a rare winter abundance of flowers, seeds and fruit for peckish wildlife to nibble. You’ll find Winter birds make this place especially playful and lively.

Originally created in 1949, the Winter Garden underwent a substantial renovation in 1988. Credit for the garden’s design belongs to Professor Iain Robertson, of the University of Washington School of Landscape Architecture. He imagined a “woodland room” in keeping with the character of the Washington Park Arboretum. You’ll see Western Red Cedar and Douglas Fir Trees create a backdrop for striking winter plants. Arboretum staff keeps an extensive, ever changing plant list that includes many rare and unusual treasures. Natives grow among them to further integrate this special place with its surrounding forest. An inviting expanse of lawn invites visitors into the center of the garden. Deservingly, the garden was named in honor of Joseph A. Witt. The long-time curator was especially devoted to this “Functional Landscape” Collection. Thanks goes to the Arboretum Foundation for the funding support for this renovation.

To find the Joseph A. Witt Winter Garden: leave the Graham Visitors Center, cross Arboretum Drive East, then follow the diagonal trail heading south. Other collections show beautifully through winter. Consider visiting Birches, Camellias, Hollies, Witch Hazels, and the Pinetum.

*“Hear! Hear!” screamed the jay
from a neighboring tree
where I had heard a tittering
for some time,
“Winter has a concentrated
and nutty kernel, if you
know where to look for it.”*

— Henry David Thoreau