

**Washington Park Arboretum – So. Entry/Madrona Terrace Project
Public Meeting #2 November 22, 2004 6 - 8 p.m.
Graham Visitors Center at the Washington Park Arboretum
2300 Arboretum Drive East**

Please join Seattle Parks and Recreation, the University of Washington and the Arboretum Foundation at a meeting to review draft schematic designs for improvements to the South Entry / Madrona Terrace area of the Washington Park Arboretum. The Arboretum Master Plan “Renewing the Washington Park Arboretum” was adopted by City Council and the University of Washington Board of regents in May 2001. The University, City and the Arboretum Foundation are working together to implement the first master plan project. The South Entry / Madrona Terrace project was prioritized because of its visibility and the ability to fulfill the primary elements of the master plan - conservation, education and recreation. This project will improve the southern entry to the Arboretum by renovating existing Arboretum features and developing new elements that are recommended in the Arboretum Master Plan. Specific elements include:

- Holmdahl Rockery: Renovate an existing 40,000 s.f. rockery designed by Otto Holmdahl in 1938 that is above Lake Washington Boulevard and the south entry to Arboretum Drive.
- Eco-geographic exhibits: Establish several “eco-geographic” exhibits that offer educational and recreational experiences for students and visitors to immerse themselves in accurate, naturalistic recreations of forest communities of the world. These provide opportunities for active conservation of endangered species from the following selected forest communities:
 - Southern Oregon/Northern California – Forests related to our Pacific Northwest plant communities, but with additional trees and shrubs that are northern elements of Californian flora, incorporating existing Madrone and other native trees.
 - Chile – A demonstration of plant communities emphasizing the forests of the Lakes District in south central Chile, one of the principal sources of new, ecologically appropriate landscape plants for the Northwest
 - Australia. – A small exhibit of plants from regions that are typically considerably warmer than the Puget Sound area.
 - New Zealand – Incorporating a hardy plants from the Southern Alps.
 - China – An eco-geographic collection representing the forests of Mount Omei, located across Lake Washington Blvd. and northeast of the Japanese Garden.
- Irrigation: Design irrigation for all affected landscaping.
- Parking: Locate and design a 30-space parking lot at the Madrona Terrace near the south end of Arboretum Drive, to support a new education shelter.
- Education Shelter: Design a 300 square foot education shelter and adjacent displays to interpret the nearby plant communities of cool, winter-rain regions of the world.
- Interpretive and Wayfinding Signs: Identify locations and provide graphic signs that are consistent with the approved wayfinding and interpretation plan.

For more information, please visit the following web sites: <http://depts.washington.edu/wpa/> or <http://www.seattle.gov/parks/proparks/projects/arboretum.htm> or contact David W. Goldberg, 800 Maynard Ave. S, 3rd Floor Seattle, WA 98134-1336

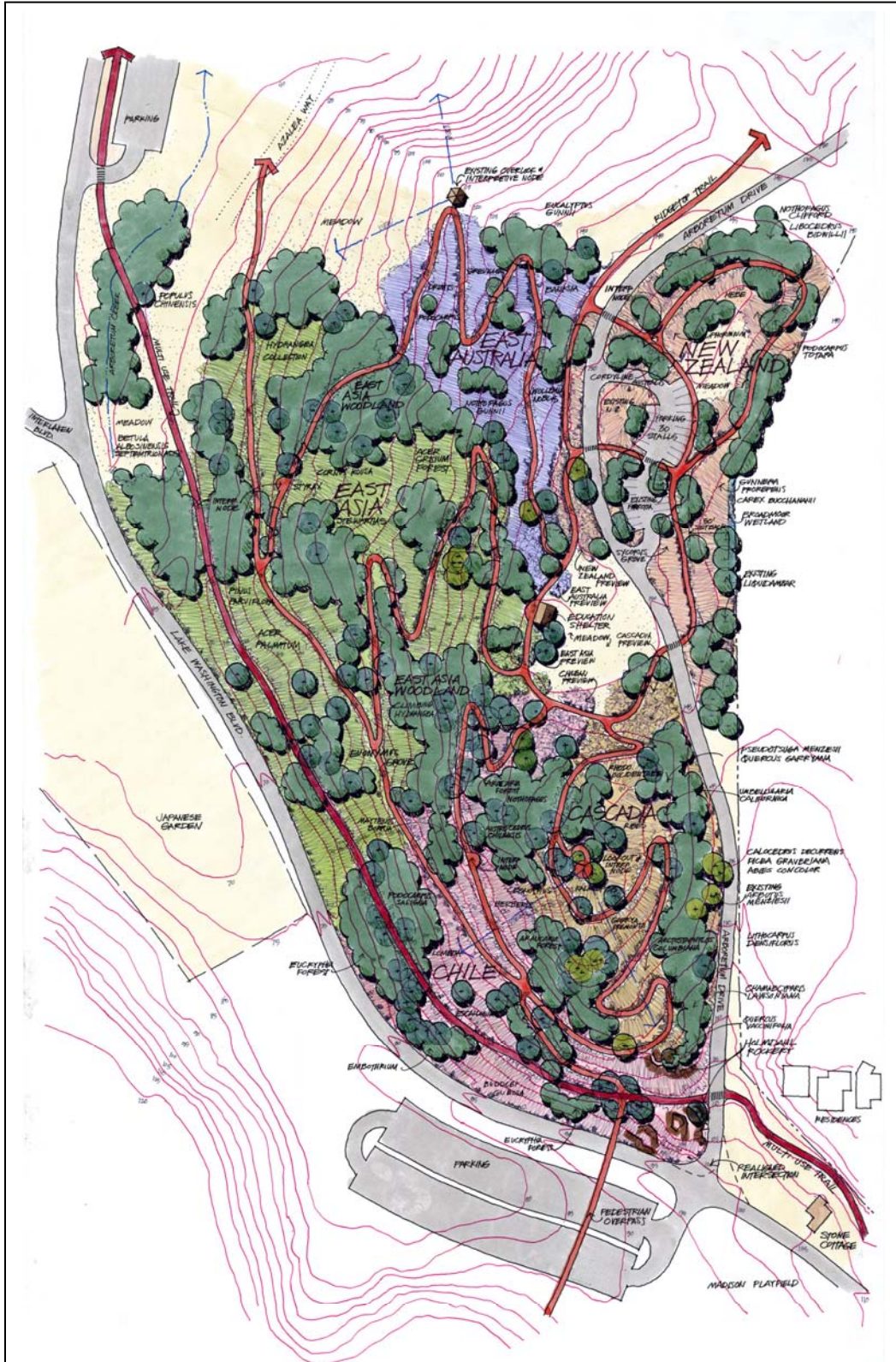

**DRAFT SCHEMATIC DESIGN
PACIFIC RIM GEOGRAPHIC COLLECTIONS**

**SOUTH ENTRY - MADRONA TERRACE
WASHINGTON PARK ARBORETUM**

THE PORELO GROUP

 DAN HINKLEY
 SCOTT MEDENDORP
 2010 ENGINEERING
 CAROL HEGON
 BLUBWATER

SEATTLE PARKS and RECREATION · UNIVERSITY OF WASHINGTON · ARBORETUM FOUNDATION

26 OCTOBER 2004  0' 30" = 1"