

1394-577

Given under my hand and official seal this 7th day of December, A. D. 1928.

(H. A. W. Notarial Seal)  
(Com. Ex. July 22, 1930)

Horace A. Wilson  
Notary Public in and for the State of Washington,  
residing at Seattle.

Filed for record at request of Mike Desimone, Dec. 7, 1928 at 44 min. past 2 P. M.

IWP *HWA*

George A. Grant, County Auditor

2608494

Edward H. Stafford, et al

# Restriction

THIS INDENTURE WITNESSETH: That for and in consideration of the sum of Five Dollars, in hand paid each to the other, receipt whereof is hereby acknowledged, and of the mutual benefits, protection, preservation and promotion of the value of the land and properties of the several makers of this indenture hereinafter described, being lands used and held for residence purposes in what is called the Capitol Hill District of Seattle, and comprising several Additions now of record in the Auditor's office in King County, State of Washington the particular description of the lands and Additions to which this instrument applies is contained in and follows the several signatures of the makers of this instrument.

The parties hereto signing and executing this instrument and the several like instruments relating to their several properties in said district, hereby mutually covenant, promise and agree each with the others, and for their respective heirs and assigns, that no part of the lands owned by them as described following their signatures to this instrument, shall ever be used or occupied by or sold, conveyed, leased, rented or given to negroes or any person or persons of the negro blood.

This covenant shall run with the land and bind the respective heirs and assigns of the parties hereto, and of the several like instruments in said district, for the period of twenty-one (21) years from and after the date of this instrument, the intent being on the part of each to and with the others executing like instruments, that there shall be privity of contract between the parties so executing like and similar instruments in said district, whether they sign each of the instruments or not.

Executed this 3rd day of December, 1928.

Edward H. Stafford

Ruth H. Stafford  
Owners of the following property:

Edward H. Stafford - West 40 of North 45 of Lot 8, Block 30, Law's Addn.

L. E. Pedersen

Estelle M. Pedersen  
Owners of the following property:

Estelle M. Pedersen - South 2 of Lot 1, and North 27 of Lot 2, Block 2, D. M. Crane's Addn.

C. T. Bellinger

Mrs. C. T. Bellinger  
Owners of the following property:

C. T. Bellinger - South 13 of Lot 2, and North 16 of Lot 3, Block 2, D. M. Crane's Addn.

Nicholas F. Zeyen

Margaret C. Zeyen  
Owners of the following property:

J. H. Scott - South 24 of Lot 3, And North 5 of Lot 4, Block 2, D. M. Crane's Addn.

T. C. Thompson

Nettie A. Thompson  
Owners of the following property:

T. C. Thompson - South 35 of Lot 4, Block 2, D. M. Crane's Addn.

Hannah M. Gifford  
Owners of the following property:

Carl Klemschmidt - Lot 5 and 6, Block 2, D. M. Crane's Addn.

Leopold Goldsmith

Bella Goldsmith  
Owners of the following property:

Leopold Goldsmith - Lots 7 and 8, Block 2, D. M. Crane's Addn.

Owners of the following property:

J. E. Hudson David  
Owners of the following property:

J. E. Hudson - Ely. 75 of Lot 9, Block 2, D. M. Crane's Addn.

Frank Reber

Marie Reber  
Owners of the following property:

Frank Reber - North 15 and Ely. 75 of So. 25 of Lot 10, Block 2, D. M. Crane's Addn.

Owners of the following property:

1394-578

John C. Morgan

Nancy Morgan  
Owners of the following property:J. C. Morgan - Lot 12, Block 2, D. M. Crane's Addn.

Loue Capelato

Parla Capelato  
Owners of the following property:Albert Wilton et ux - Lot 13, Block 2, D. M. Crane's Addn.

L. W. Mines

O. C. Lohman  
Owners of the following property:John Astnes - South 30<sup>th</sup> of Lot 14, Block 2, D. M. Crane's Addn., subject to present tenancy in south garage.

Harry Hunt

Owners of the following property:

Harry Hunt - North 10 of Lot 14 and So. 20 of Lot 15, Block 2, D. M. Crane's Addn.

Kate Doolittle

Owners of the following property:

Kate Doolittle - North 20 of Lot 15, and unplatted strip on north of Lot 16, Block 2, D. M. Crane's Addn.

Mrs. Ellen Sharkey

Owners of the following property:

Thomas J. Sharkey - Lot 1, Block 30, Law's Addn.

Ida R. Bell

W. S. Bell

Owners of the following property:

Ida R. Bell - Lot 2, Block 30, Law's Addn.

Owners of the following property:

W. D. Schenkar

S. Schenkar

Owners of the following property:

W. D. Schenkar - North 35 of Lot 4, Block 30, Law's Addn.

W. D. Schenkar

S. Schenkar

Owners of the following property:

W. D. Schenkar - South 17<sup>1</sup>/<sub>2</sub> of Lot 4, Block 30, Law's Addn. and No. 12' of Lot 1, Block 2, D. M. Crane's Commencing at N. W. corner of Lot 1, Block 2, D. M. Crane's thence north 8.03' more or less along the east line of 17th Ave. North to the North line of the south half of the S. W. quarter of section 28 Township 25 N. Range 4, east 120 to alley S. 7.85 to N. E. corner Lot 1 West 120 to place of beginning.

The Bank for Savings in Seattle

J. R. Auzias de Turenne  
V. P.

Owners of the following property:

Bank of Savings in Seattle, Inc. - Lot 5, Block 30, Law's Addn.

Feder P. Gjarde

Amenda L. Gjarde

Owners of the following property:

Feder P. Gjarde - Lot 6, Block 30, Law's Addn.

Sarah J. Cude

William Cude

Owners of the following property:

William Cude - South 30 of Lot 7, Block 30, Law's Addn.

Carrie B. Turpin

Mrs. Frank Turpin

E. F. Turpin

Owners of the following property:

Cecil B. Jordon - North 22<sup>1</sup>/<sub>2</sub> of Lot 7, Block 30, Law's Addn. and South 7<sup>1</sup>/<sub>2</sub> of Lot 8, Block 30, Law's Addn.

Percy B. Cahail

Owners of the following property:

P. B. Cahail - East 80 of North 45 of Lot 8, Block 30, Law's Addn.

(THE M. N. B. of S. Corp. Seal)

THE MARINE NATIONAL BANK OF SEATTLE  
as Executor of the Est. of Belle R. Hall, deceased.

Ira W. Bedle

Vice Pres.

C. O. Ousdahl

Asst. Cashier  
Owners of the following property:

Belle R. Hall - Lot 2 Block 14 Law's Addn.

R. U. S.

# The D.M. Crane Addition.

To the

CITY OF SEATTLE

WASH.

Scale 1 inch equals 100 ft.

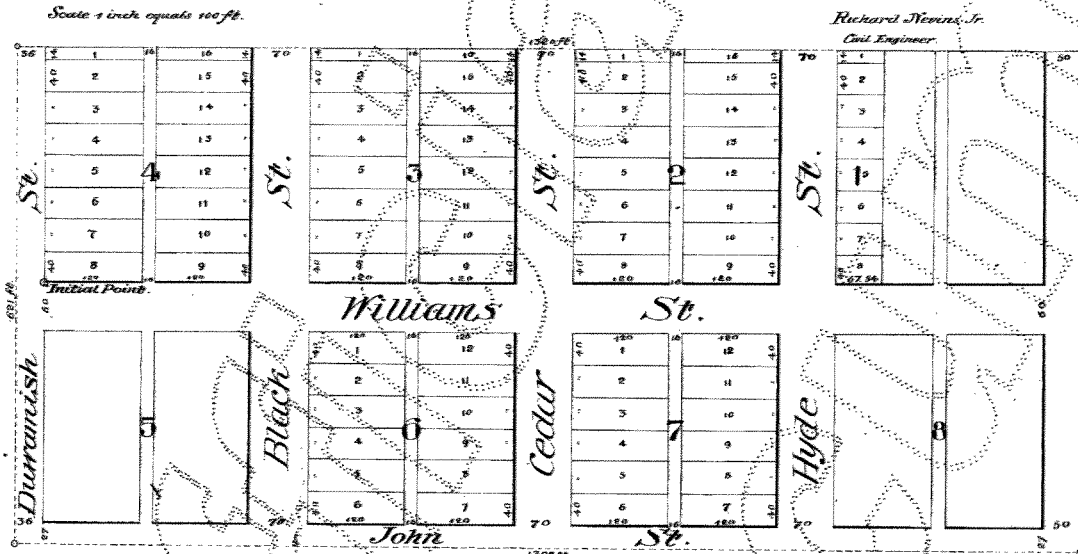

## DESCRIPTION.

The D.M. Crane Addition, to the City of Seattle, Washington, is situated in the S.W. 1/4 of the S.W. 1/4 of Section 28 Township 25 North, Range 4 East. The Initial Point of this plat is the S.W. corner of Lot 8, Block 4 which is 1924 feet North and 56 feet East of the S.W. corner of Section 28 Township 25 N. Range 4 E. N.W. 1/4. All streets and alleys running North and South, conform with Laws of this State. Sizes of Lots and widths of Streets and Alleys are as marked on the face of the plat in feet.

45221.

Filed for Record at the request of Walter Hall, July 8 A.M. 1930, at 10 min past 7 of AM and recorded in Vol. 11 of Photo page 11 Records of King County Wash. By Deputy County Auditor

## DEDICATION.

Know all men by these presents, That we, Sarah E. Hall, Laura E. Hall, (now intermarried with Charles Peters) and William C. Bardsley, owners in fee simple of the real property on which is located the above named D.M. Crane Addition to the City of Seattle, do hereby declare this plat and do hereby dedicate to the use of the public forever all the streets and alleys, platted herein.

Witness our hands and seals this 20th day of December 1929.

Signed and sealed in presence of  
I. M. Hall  
W. A. Hall  
Sarah E. Hall  
Laura E. Peters  
By Sarah E. Hall  
her Attorney-in-fact.

William C. Bardsley

Approved by the Mayor and Common Council of the City of Seattle this 6th day of July 1930.  
Attest  
C. W. Morris  
City Clerk

## ACKNOWLEDGMENT.

State of Washington,  
County of King,  
City of Seattle.

This is to certify that on this 20th day of December 1929 before me, I. M. Hall, a Notary Public in and for the Territory (now State) of Washington, duly commissioned and sworn, personally appeared William C. Bardsley and Sarah E. Hall for herself and also as attorney in fact for Laura E. Hall (now intermarried with Charles Peters) (none knowing to be the identical persons, described in and who executed this instrument, and they severally acknowledged to me that they signed and sealed this said instrument freely and voluntarily for the uses and purposes therein mentioned; and the said Sarah E. Hall further acknowledged to me, that she freely and voluntarily signed the name of the said Laura E. Peters and affixed her seal to this said instrument as the free and voluntary act and deed of the said Laura E. Peters.

In Witness whereof I have hereunto set my hand and affixed my Notarial seal the day and year in this certificate above written.

I. M. Hall,  
Notary Public in and for the State of Washington,  
(formerly Territory of Washington.)

