

1824-883

ribed, and to
the sewer in
cessors and
scified, a
or the following

ribed premises.
ed by said

of the City of
times as may
d testing said

he party of

to prevent the
benefited in
n sewer.
he day and year

a Notary Public
l. Bolt, to
that he signed
in mentioned.

State of Wash-

r

and, for and
llowing des-
ing to plat

and for
lson and
cuted the
t as their

1775836

1775865

WITNESS my hand and official seal hereto affixed the day and year in this certificate above written.
(C.E.J. Notarial Seal)
(Com. Ex. Apr. 2, 1926)
C. E. Johnson,
Notary Public in and for the State of Washington,
residing at Seattle.

Filed for record at request of Grantee, Jan. 16, 1923, at 59 min past 10 A.M. and recorded in Vol. 1190 of Deeds, at page 401, Records of King County Washington, D. E. Ferguson, County Auditor, by S. C. Whittington, Deputy.
Aud. Note: re-recorded to show change in party clause.
Filed for re-record at request of Grantee, Sep. 4, 1923, at 16 min past 9 A.M.

ER *Jm* D. E. Ferguson, County Auditor

A. G. Worthington
To
Dorothy Dean Worthington
Quit Claim Deed

STATUTORY QUIT CLAIM DEED

THE GRANTOR, A.G. Worthington, for and in consideration of One dollar, love and affection, Dollars, conveys and quit claim to Dorothy Dean Worthington, as her sole and separate property, all interest in the following described real estate:

The south half of Southeast quarter of northwest quarter of northeast quarter of Section 7, Township 26 north, range 5 east, W. M. containing 5 acres, more or less, less portion thereof now used for road purposes.

situated in the County of King, State of Washington.
Dated this 28th day of August, A.D. 1923.

A. G. Worthington (Seal)

State of Washington
)ss
County of King

On this 28th day of August, A.D. 1923, before me, the undersigned, a Notary Public in and for the State of Washington, duly commissioned and sworn, personally appeared A. G. Worthington, husband of Dorothy Dean Worthington, to me known to be the individual described in and who executed the foregoing instrument, and acknowledged to me that he signed and sealed the said instrument as his free and voluntary act and deed for the uses and purposes therein mentioned.

WITNESS my hand and official seal hereto affixed the day and year in this certificate above written.
(W.L.E. Notarial Seal)
(Com. Ex. June 13, 1925)
Wm. L. Ellis
Notary Public in and for the State of Washington,
residing at Bothell

Filed for record at request of Grantee, Sep. 4, 1923, at 22 min past 9 A.M.
ER *Jm* D. E. Ferguson, County Auditor

Thomas Wallace et ux
To
J. F. Fogarty
Real Estate Contract

IT IS HEREBY AGREED by and between Thomas Wallace and Emma F. Wallace, his wife, first parties, hereinafter called the vendors, and J. F. Fogarty, second party, hereinafter named as the purchaser, that the said vendors will sell and the said purchaser will purchase the following described real estate located in Seattle, King County, Washington, to-wit:

Lot 12, Block 11, Maynard's Lake Washington Addition, to the City of Seattle,
with appurtenances, which we have sold to said purchaser upon the following terms and conditions:
The purchase price of said property is the sum of Thirty six Hundred Fifty & No/100 (\$3650.00) Dollars, of which the sum of Five Hundred (\$500.00) Dollars, has this day been paid, and the balance to be paid as follows: The sum of Thirty (\$30.00) Dollars to be paid on or before the 1st day of December, 1918, and the further sum of Thirty (\$30.00) Dollars to be paid on or before the 1st day of each and every month thereafter until the full purchase price is paid, with interest at the rate of seven per cent (7%) per annum: Each thirty dollar monthly installment includes the interest to the date thereof, and the balance shall be applied on the principal:
The purchaser agrees to pay before delinquency all taxes, assessments or impositions levied, assessed or placed against said property subsequent to the date hereof.

Said land to be conveyed by warranty deed when purchase price is fully paid. Purchaser agrees not to convey said property to Japanese, Chinese, Africans or other persons not of the Caucasian race.

1202-584

Time is of the essence of this agreement and in the event the second party fails to meet his payments or perform any of the covenants by him to be performed under this contract, this contract, shall be forfeited and determined at the election of the vendors, and all payments made by the purchaser hereon shall, at their option, be forfeited as liquidated damages to the vendors for the breach of this contract, and the vendors may re-enter and take possession of said land and premises and every part thereof. It is further agreed that the purchaser will keep insurance on this property in an amount not less than two thousand dollars.

WITNESS our hands and seal in duplicate this 22nd day of November, 1919:

EXECUTED IN DUPLICATE

Emma F. Wallace

Thomas Wallace

VENDORS

J. F. Fogarty

PURCHASER

State of Washington)ss
County of King

THIS IS TO CERTIFY, That on this 22nd day of November, 1919, before me, a Notary Public in and for the State of Washington, duly commissioned and sworn, personally came Thomas Wallace and Emma F. Wallace, his wife, and J. F. Fogarty, to me known to be the individuals described in and who executed the within instrument, and acknowledged to me that they signed and sealed the same as their free and voluntary act and deed for the uses and purposes therein mentioned.

WITNESS my hand and official seal this 22nd day of November, 1919:

(C.E.B. Notarial Seal)

C. E. Burroughs

(Com. Ex. May 21, 1923)

Notary Public in and for the State of Washington, residing at Seattle.

State of Washington)ss
County of King

Emma F. Wallace & Thomas Wallace, being first duly sworn, on oath says: That they are the sole owners of said property and have executed the within instrument in the above entitled action; that they have read the foregoing contracts, know the contents thereof, and that they believe the same to be true;

Subscribed and sworn to before me this 22 day of Nov. 1919.

(C.E.B. Notarial Seal)

C. E. Burroughs

(Com. Ex. May 21, 1923)

Notary Public in and for the State of Washington, residing at Seattle.

Filed for record at request of J. F. Fogarty, Sep. 4, 1923, at 39 min past 9 A.M.

ER *[Signature]*

D. E. Ferguson, County Auditor

###

1775872

John H. Schade et ux

To

Warranty Deed

Tim R. Connell et ux

THE GRANTORS, John H. Schade and Mary A. Schade, his wife, for and in consideration of Thirty five Hundred and no/100 Dollars in hand paid, convey and warrant to Tim R. Connell and Ruby Connell, his wife, the following described Real Estate:

The east forty feet of lot six (6) and the east forty feet of the north twenty four feet of lot seven (7) in block sixty four (64) Riley's Addition to Riley's Addition to South Seattle, W.T., according to plat recorded in Volume 17 of Plats, at page 11 of records of King County, Washington, Situated in the County of King, State of Washington.

Dated this 11th day of August, 1923.

WITNESSES:

John H. Schade (Seal)

Mary A. Schade (Seal)

State of Washington)ss
County of Benton

I, the undersigned, a Notary Public, do hereby certify that on this 11th day of August, 1923, personally appeared before me John H. Schade and Mary A. Schade, his wife, to me known to be the individuals described in, and who executed the within instrument, and acknowledged that they signed and sealed the same as their free and voluntary act and deed for the uses and purposes therein mentioned.

PLAT
OF

Maynard's Lake Washington Addition

To The

City of Seattle

King County, W.T.

Scale: 400 Ft. to 1 inch.
Surveyed by Snow & Munch.

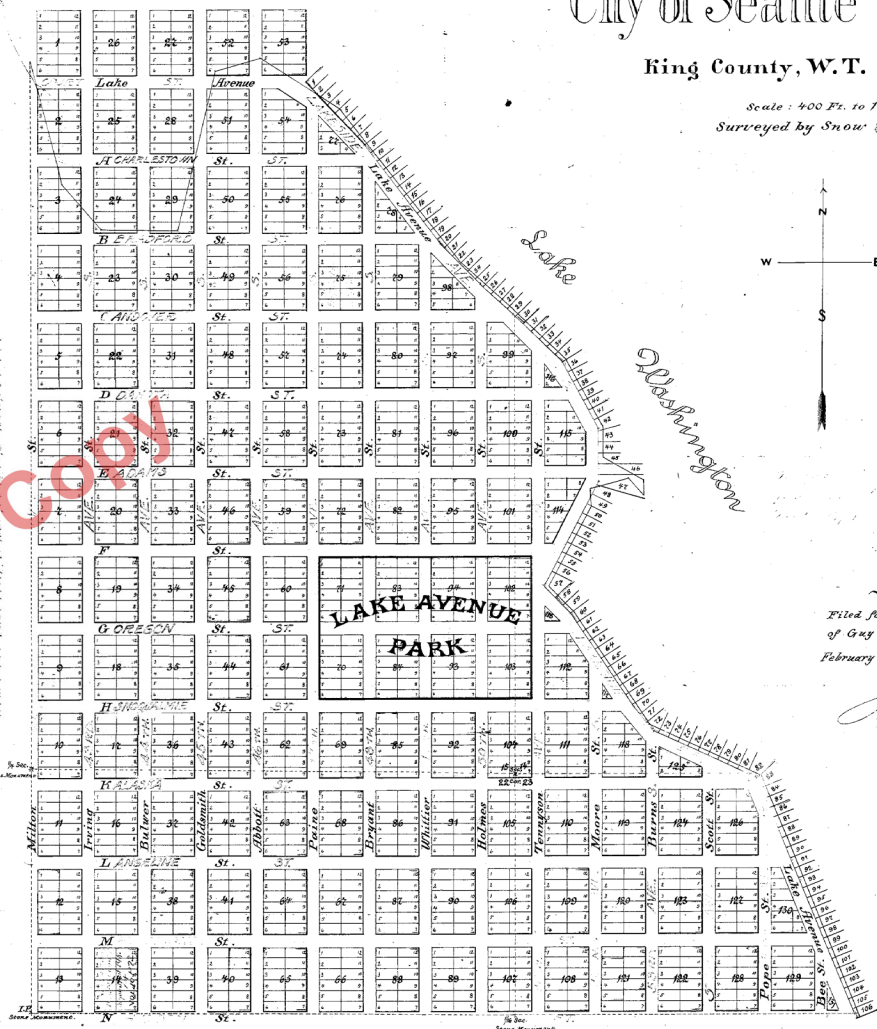

~ 4258 ~

Filed for Record at the request
of Guy C. Phinney.

February 6th A.D. 1884 at 30 min past 10 A.M.

[Signature]
County Auditor.

DESCRIPTION

This Addition covers all of the East half of Section 15, the North half of the North East 1/4 of Section 22, Lots 1 & 2 of Section 16 and Lot 8 of Section 33, Township 24 North, Range 4 East, Willamette Meridian, in King County, Washington Territory.

The initial point is the 1/4 Section corner, which is 122.5 feet South of the 1/4 Section corner on the line between Sections 15 and 22, this initial point is 9.5 feet South of and 35.0 feet West of the South-West corner of Block 13 of this plat.

All Streets are 70 feet wide.

Lots are 60 by 120 feet, except those in the fractional blocks which are of the dimensions marked in the plat.

DEDICATION

Territory of Washington, s.s.
County of King

Know all men by this presents that we Guy C. Phinney and Nellie Phinney Owners, have this 26th day of January A.D. 1884 placed the Maynard's Lake Washington Addition to the City of Seattle as shown on this plat, and that we hereby dedicate all streets shown on said plat to the use of the public forever, except those in Lake Avenue Park, and reserving the exclusive rights of laying down water and gas pipes through and under the streets of said plat.

Witness: G. C. Phinney, S
Nellie Phinney, S
Soft. Byink, S
D. T. Wheeler.

Personally appeared this 26th day of January A.D. 1884 before me a Notary Public in and for King County and Washington Territory the within named Guy C. Phinney and his wife Nellie Phinney to me known to be the parties whose names are affixed to the foregoing dedication, and each acknowledged to me that they executed the same freely and voluntarily and for the uses and purposes therein mentioned.

And the said Nellie Phinney, wife of Guy C. Phinney, being examined by me separately and apart from her said husband and being informed by me of the nature and extent of the above named dedication, acknowledged that she executed the same freely and voluntarily and without fear or coercion of her said husband.

In witness whereof I have hereunto set my hand and affixed my official seal this 26th day of January A.D. 1884.

D. T. Wheeler,
Notary Public in and for King County,
Washington Territory.

NOTARIAL
SEAL